



Owner's Handbook

BW-678-S148

Handheld Vacuum Cleaner

IMPORTANT SAFETY CAUTIONS	1	CHARGING THE CLEANER.....	9
CLEANING AND MAINTENANCE.....	4	ASSEMBLING THE CLEANER	9
Emptying the dust container	4	Fitting an attachment	9
Cleaning the filter.....	4	Removing the attachments	9
Reassembling the dust container	4	OPERATION.....	10
Cleaning the exterior	4	Preparation for use.....	10
INTRODUCTION.....	5	Using the cleaner.....	10
Vacuum cleaner features	5	Cautions when cleaning	10
Taking care of your cleaner	5	When to re-charge	10
UNPACKING.....	5	Blockages	10
MOUNTING THE CHARGING BRACKET	6	AFTER USE	10
Charging bracket mounting cautions	6	TROUBLESHOOTING	11
CONTROLS AND FEATURES.....	7	SPECIFICATIONS.....	11
ACCESSORIES	8	WARRANTY	12

Please keep your sales docket, including cash register receipt, in a safe place as the docket will prove the commencement of the period of this warranty. If you wish to make a claim specifically under this manufacturer's warranty, you will be required to provide proof of purchase, preferably your sales docket.

IMPORTANT SAFETY CAUTIONS

Please read these instructions carefully before using the appliance for the first time.

WARNING- to reduce the risk of fire, electric shock or injury to persons or property:

- Use the charger from a power outlet of the same voltage (A.C. only) as marked on the rating label of the charger.
- Charge the vacuum cleaner only with the original charger supplied with the vacuum cleaner.
- Always turn the power off at the power outlet before you insert or remove the charger. Remove by grasping the plug, do not pull on the cord.
- Do not handle the charger with wet hands.
- Never use the appliance if it has dropped, been damaged, left outside, or has fallen into water.
- Store the vacuum cleaner indoors on its charging bracket.
- Do not immerse the appliance in water or any other liquid.
- Turn off all controls before charging the cleaner.
- Check the dust container each time you start vacuuming. Empty it if necessary.
- Always empty the dust container promptly if the appliance has been used to pick up liquid.
- Do not put any object into openings. Do not use with any opening blocked. Keep free of dust, lint, hair and anything that may reduce air flow.
- Keep hair, loose clothing, jewellery, fingers and all parts of the body away from openings and moving parts.

IMPORTANT SAFETY CAUTIONS

- Before you start using the vacuum cleaner, remove large or sharp objects from the floor in order to prevent damage to the paper filter.
- Do not use the cleaner to pick up hard or metal objects, nails pins, etc.
- Do not use the cleaner to pick up powdery spills such as cement or flour.
- Do not pick up toxic material (chlorine bleach, ammonia, drain cleaner etc).
- Do not use in an enclosed space filled with vapours given off by oil based paints, paint thinner, moth proofing, flammable dust, or other explosive or toxic vapours.
- Do not use the cleaner to pick up flammable or combustible liquids, such as petrol, solvents, paints, or gas, or use in areas where they may be present.
- Do not pick up anything that is burning or smoking, such as cigarettes, matches, or hot ashes.
- Do not operate the vacuum cleaner when it is too close to heaters, radiators, cigarette butts etc.
- Use extra care when cleaning on stairs.
- Keep the end of the nozzle attachments and other openings away from your face and body.
- Do not use without the dust container and/or filter in place.
- Always switch off this appliance before connecting or disconnecting attachments.
- If the opening that sucks in the air or attachments are blocked, switch off the vacuum cleaner at once. First clear the blocked substance before you attempt to start the vacuum cleaner again.

IMPORTANT SAFETY CAUTIONS

- Use only as described in this user's guide. Use only the manufacturer's recommended attachments.
- Do not allow the cleaner to be used as a toy. Close attention is necessary when used nearby children.
- This appliance is not intended for use by persons (including children) with reduced physical, sensory or mental capabilities, or lack of experience and knowledge, unless they have been given supervision or instruction concerning use of the appliance by a person responsible for their safety.
- Children should be supervised to ensure that they do not play with the appliance.

CLEANING AND MAINTENANCE

Never clean any of the cleaner components with scourers, abrasive pads or chemicals.

Emptying the dust container

CAUTION: Always empty the dust container and clean the filter immediately after picking up fluid spills.

NOTE: For best cleaning performance, empty the dust container and clean the filter regularly. Never wait until the container is full.

- Press and hold the dust container release button.
- While holding the release button, ease the dust container off the body of the cleaner.
- Remove the filter from the top of the dust container.
- Lift out the filter holder.
- Empty the container into a bin or bag.
- The dust container can be washed if required in a mild detergent solution.
- Allow the container to dry thoroughly.

Cleaning the filter

- Brush the outside of the filter with a soft paintbrush or similar to remove dust from the filter.
- Rinse the filter in running water.
- Leave the filter in a warm place for 24 hours to dry thoroughly before reassembly.

CAUTION: Never wash the filter in a washing machine or use a hairdryer to dry it.

Reassembling the dust container

- Fit the filter holder into the top of the dust container.
- Place the filter into the holder.
- Engage the clip under the cleaner body into the slot in the dust container.
- Rotate the dust container into position..

The dust container will click in place on the catch.

Cleaning the exterior

- The exterior of the cleaner can be wiped clean with a barely damp cloth.
- Dry thoroughly before use.

INTRODUCTION

Vacuum cleaner features

- Compact design.
- Wet or dry operation.
- Rechargeable for portable use.

Taking care of your cleaner

CAUTION

For ease of maintenance, your cleaner has a bagless dust container. For this system to work efficiently, the container must be emptied on a regular basis. The filter should also be cleaned regularly.

If the container is over-full or if the filter becomes blocked, suction will reduce significantly and the cleaner may overheat. Permanent damage could result from overheating.

Always empty the dust container immediately after picking up fluid spills.

UNPACKING

Unpack the vacuum cleaner from the carton.

Retain the carton and packing for future use. If you have to dispose of the carton and packing, please do so responsibly.

The carton should contain -

1 x BW-678-S148 vacuum cleaner.

1 x Charger ZD12D180050AU.

1 x Storage/Charging bracket.

1 x Fixings for the bracket.

2 x Nozzle attachments for dry and wet use.

1 x Owner's handbook.

Remove any tape or sponge packaging that may be securing the power button in the 'OFF' position.

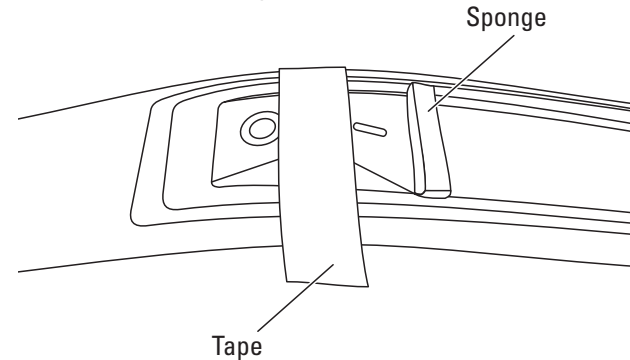

MOUNTING THE CHARGING BRACKET

The charging bracket should be mounted on a wall with the charging plug facing upwards.

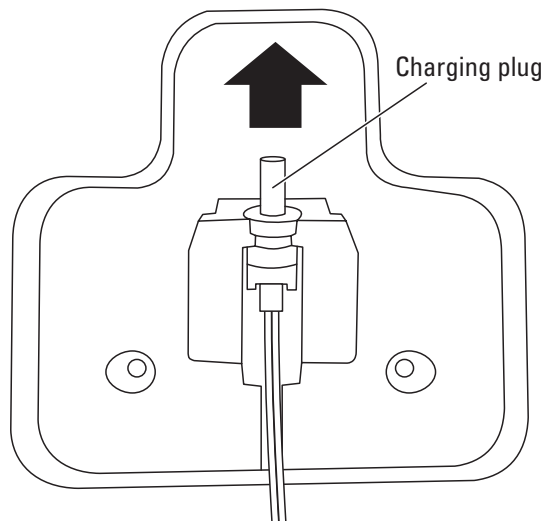

Choose a location that is accessible, with mains power in reach of the charger, and out of reach of children and pets.

Mounting methods may vary depending on the construction of the wall. Use the supplied mounting screws and wall plugs if these are the correct fixing type for your wall. Check that the bracket is mounted securely before use.

Charging bracket mounting cautions

Always check there are no wires, pipes etc concealed in the wall where you are planning to mount the bracket.

Always wear personal protection equipment when using power tools.

Consult a building professional if you are in any doubt about mounting the bracket.

CONTROLS AND FEATURES

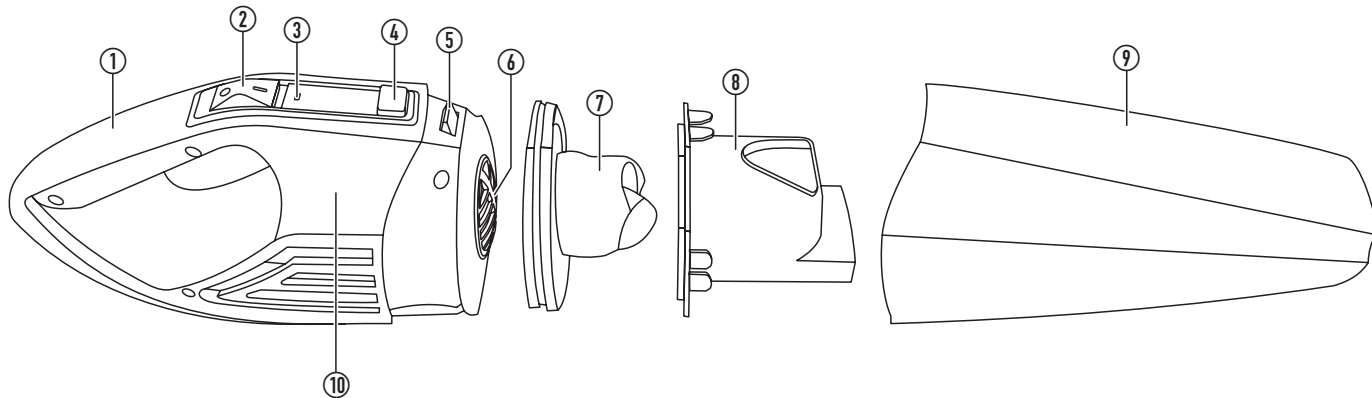

1. Handle
2. Power switch
3. Power/Charge indicator
4. Dust container release button
5. Dust container catch

6. Air inlet
7. Filter
8. Filter holder
9. Dust container
10. Motor body

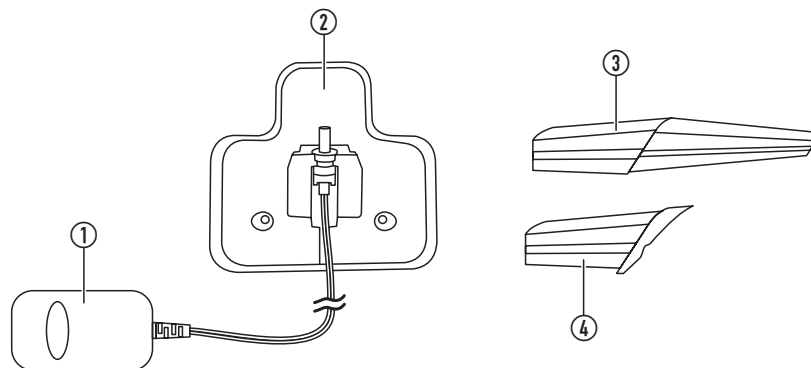
ACCESSORIES

1. Charger ZD12D180050AU
2. Charging bracket
3. Dry cleaning nozzle
4. Wet cleaning nozzle

CHARGING THE CLEANER

- Place the cleaner on its storage bracket.
- Connect the charger to mains power.

The power indicator will light red and the cleaner will charge.

When fully charged the power indicator will change to green.

- Disconnect the charger.

ASSEMBLING THE CLEANER

Fitting an attachment

- Choose an attachment and push the stem of the attachment into the air inlet of the cleaner.

The cleaner is now ready to use.

Removing the attachments

The attachments are a push fit in the air inlet, there is no catch to retain them.

- Holding the cleaner by the dust container, pull the attachment out of the air inlet.

OPERATION

Preparation for use

- Lift the vacuum cleaner off its charging bracket.
- Check that the power switch is set to the '0' (off) position.
- Empty the dust container if necessary.
- Fit the attachment you want to use and the extension handle (if required).

Using the cleaner

- Holding the handle firmly, set the power switch to the '1' (on) position.

The power indicator will light green and the cleaner will switch on.

- Carefully apply the tip of the nozzle to the areas you want to clean.

The suction will be high at the tip of the nozzle. If the cleaner inadvertently sucks in curtains or soft furnishing material, switch it off immediately and remove it carefully from the nozzle.

Cautions when cleaning

- Take extra care when using the cleaner on stairs.
- Never operate the cleaner with the filters removed.

When to re-charge

- The cleaner should be re-charged fully before first use and after each use.

If the power indicator changes to red during use, battery power is low and the cleaner will require charging fully soon.

- Return the cleaner to the charging bracket to re-charge.

Blockages

- If you suspect there is a blockage, switch off the cleaner immediately to avoid damage.
- If one of the attachments is blocked, disconnect the power cord and remove the attachment.
- Use a screwdriver or similar tool to clear the blockage.

AFTER USE

- Set the power switch to the '0' (off) position.
- Follow the instructions in the Care and Cleaning section to check if the dust container should be emptied and clean the filters if necessary.
- Store the cleaner on its charging bracket. Connect the charger to mains power if charging is required.

TROUBLESHOOTING

No power	Re-charge the cleaner.
Reduced suction	Switch off the cleaner. Check if the dust container is fitted correctly and is empty of dust. Check if the filter is clean.
	If the problem persists, check if there is a blockage in the attachments.
Dust clouds from the cleaner	Switch off the cleaner. Check if the dust container is fitted correctly and is empty of dust.
Cleaner cuts out in use	The cleaner may need charging. Return it to the charging bracket until charged.
	The motor may have overheated. Switch off and unplug the cleaner and leave it to stand for 1 hour before using it again. If the cleaner overheats, it is most likely to be due to blocked filters. Always check all the filters if the cleaner has cut out in use.

SPECIFICATIONS

Charger power supply.....100 - 240V~, 50/60Hz, 500mA

Charger output.....18V == 500mA



Class II double insulated.



WARRANTY

1. Our goods come with guarantees that cannot be excluded under the Australian Consumer Law. You are entitled to a replacement or refund for a major failure and for compensation for any other reasonably foreseeable loss or damage. You are also entitled to have the goods repaired or replaced if the goods fail to be of acceptable quality and the failure does not amount to a major failure. Where a failure does not amount to a major failure, BIG W is entitled to choose between providing you with a repair, replacement or refund. To obtain compensation, you would need to provide documentary evidence of the loss or damage suffered, and documentary evidence that such loss or damage was a reasonably foreseeable consequence of a failure by BIG W to comply with a consumer guarantee under the Australian Consumer Law. Such evidence may include photographs, statutory declarations, receipts or reports (eg from your doctor), depending on the loss or damage.
2. In addition to all rights and remedies to which you may be entitled under the Competition and Consumer Act 2010 (Commonwealth) and any other relevant legislation, the manufacturer warrants this product to be free from defects in materials or workmanship for a period of 24 months from the date of purchase.
3. In order to claim under this warranty you will need to bring the product to any BIG W store, along with proof of purchase (typically this will be a receipt). Any cost incurred by you in bringing the product to the service desk will be borne by you. We will then, at our option, either repair or replace the product, or refund your money and take back the product – in accordance with our Returns Policy, a copy of which is available at our return desk
4. Our liability under this manufacturer's warranty is subject to us being satisfied that a defect was caused by defective workmanship or materials, and was not caused by or substantially contributed to by other factors, or circumstances beyond our control, including (but not limited to) defective installation, maintenance or repair, alteration or modification of the product in a manner not recommended by the manufacturers or any neglect, misuse or excessive use.
5. The benefits conferred by this manufacturer's warranty are in addition to all rights and remedies conveyed by the Competition and Consumer Act 2010 (Commonwealth), and any other statutory rights to which you may already be entitled, and this warranty does not exclude, restrict or modify any such rights or remedies that are implied by law.
6. This warranty is provided by BIG W of 1 Woolworths Way, Bella Vista NSW 2153, Phone: 1300 244 999.

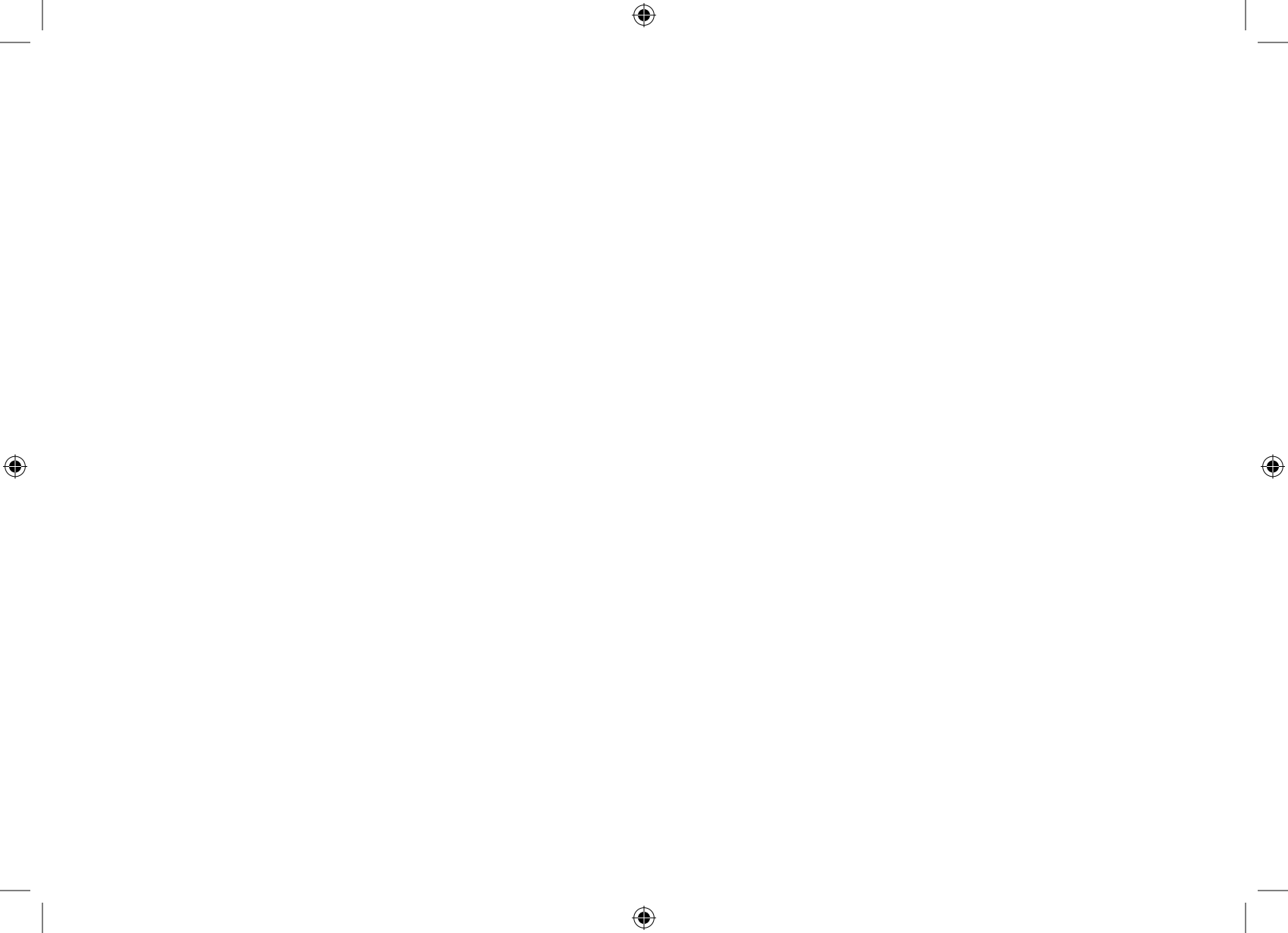

contempo™

Made for Big W
1 Woolworths Way
Bella Vista NSW
2153 Australia

Made in China

CONTEMPO BW-678-S148 V0.3