



Owner's handbook

BW-1602

Bagless Vacuum Cleaner

IMPORTANT SAFETY CAUTIONS	1	CLEANING AND MAINTENANCE.....	8
INTRODUCTION	2	Emptying the dust container	8
Vacuum cleaner features	2	Re-fitting the dust container	8
Taking care of your cleaner	2	Filters.....	9
UNPACKING.....	2	Removing the main filter	9
CONTROLS AND FEATURES.....	3	Cleaning the main filter	10
CLEANING OPTIONS	4	Re-assembling the main filter	10
Floor cleaning	4	Removing the filter grille	10
ASSEMBLING THE CLEANER	5	Re-assembling the filter grille.....	11
Fitting the hose	5	Checking the air outlet filter	11
Removing the hose	5	TROUBLESHOOTING	12
Fitting the extension tubes	5	SPECIFICATIONS.....	12
Fitting the attachments	5	WARRANTY.....	13
Removing the tubes or attachments.....	5		
OPERATION	6		
Preparation for use.....	6		
Using the cleaner.....	6		
Suction control.....	6		
Cautions when cleaning	7		
Blockages.....	7		
After use	7		
Storage	7		

Please keep your sales docket, including cash register receipt, in a safe place as the docket will prove the commencement of the period of this warranty. If you wish to make a claim specifically under this manufacturer's warranty, you will be required to provide proof of purchase, preferably your sales docket.

IMPORTANT SAFETY CAUTIONS

Please read these instructions carefully before using the appliance for the first time.

WARNING- to reduce the risk of fire, electric shock or injury to persons or property:

- Use the appliance from a power outlet of the same voltage (A.C. only) as marked on the rating label of the appliance.
- Always turn the power off at the power outlet before you insert or remove the plug. Remove by grasping the plug, do not pull on the cord.
- Do not use with a damaged cord or plug. Never use the appliance if it has dropped, been damaged, left outside, or has fallen into water.
- If the supply cord is damaged, it must be replaced by the manufacturer, its service agent or a similarly qualified person in order to avoid a hazard.
- Do not use the appliance with an extension cord.
- Do not pull or carry the appliance by the cord, do not use the cord as a handle, avoid catching the cord under doors, and do not slide it along edges or sharp edges.
- Do not run the vacuum cleaner over the cord. Keep the cord away from heated surfaces.
- Before you insert the plug into the wall socket, make sure your hand is dry.
- Do not handle the plug or vacuum cleaner with wet hands.
- This vacuum cleaner is equipped with a plug and a cable which rolls up by hand. If either get damaged, both the plug and the cable must be repaired by a qualified repairman or electrician.
- To reduce the risk of electric shock, do not use outdoors or on wet surfaces. Use only on dry, indoor surfaces.
- Store the vacuum cleaner indoors. Put the vacuum cleaner away after use to prevent tripping accidents.
- Do not immerse the appliance in water or any other liquid.
- Never leave the vacuum cleaner unattended when plugged in. Unplug from the outlet when not in use.
- Turn off all controls before connecting or unplugging the cleaner.
- Check the dust container each time you start vacuuming. Empty it if necessary.
- Do not put any object into openings. Do not use with any opening blocked. Keep free of dust, lint, hair and anything that may reduce air flow.
- Keep hair, loose clothing, jewellery, fingers and all parts of the body away from openings and moving parts.
- Before you start using the vacuum cleaner, remove large or sharp objects from the floor in order to prevent damage to the paper filter.
- Do not use the cleaner to pick up hard or metal objects, nails pins, etc.
- Do not pick up toxic material (chlorine bleach, ammonia, drain cleaner etc).
- Do not use in an enclosed space filled with vapours given off by oil based paints, paint thinner, moth proofing, flammable dust, or other explosive or toxic vapours.
- Do not use the cleaner to pick up flammable or combustible liquids, such as petrol, solvents, paints, or gas, or use in areas where they may be present.
- Do not pick up anything that is burning or smoking, such as cigarettes, matches, or hot ashes.
- Do not operate the vacuum cleaner when it is too close to heaters, radiators, cigarette butts etc.
- Use extra care when cleaning on stairs.
- Keep the end of the hose, wand and other openings away from your face and body.

IMPORTANT SAFETY CAUTIONS

- Do not use without the dust container and/or filter in place.
- Always unplug this appliance before connecting or disconnecting attachments.
- If the opening that sucks in the air or attachments are blocked, switch off the vacuum cleaner at once. First clear the blocked substance before you attempt to start the vacuum cleaner again.
- The vacuum cleaner is a powerful unit. Make sure that you hold it firmly, otherwise it may slip out of your hand and cause injury.
- Use only as described in this user's guide. Use only the manufacturer's recommended attachments.
- Do not allow the cleaner to be used as a toy. Close attention is necessary when used nearby children.
- This appliance is not intended for use by persons (including children) with reduced physical, sensory or mental capabilities, or lack of experience and knowledge, unless they have been given supervision or instruction concerning use of the appliance by a person responsible for their safety.
- Children should be supervised to ensure that they do not play with the appliance.

INTRODUCTION

Vacuum cleaner features

- Compact, high power design.
- Internal cable reel with rewind.

Taking care of your cleaner

For ease of maintenance, your cleaner has a bagless dust container. For this system to work efficiently, the container must be emptied on a regular basis. The filters must also be cleaned regularly.

If the container is over-full or if the filter becomes blocked, suction will reduce significantly and the cleaner may overheat. Permanent damage could result from overheating.

UNPACKING

Unpack the vacuum cleaner and accessories from the carton.

Retain the carton and packing for future use. If you have to dispose of the carton and packing, please do so responsibly.

The carton should contain -

- 1 x BW-1602 vacuum cleaner.
- 1 x Hose.
- 2 x Extension tubes.
- 1 x Floor cleaner attachment.
- 1 x Nozzle attachment.
- 1 x Owner's handbook.

CONTROLS AND FEATURES

BACK VIEW

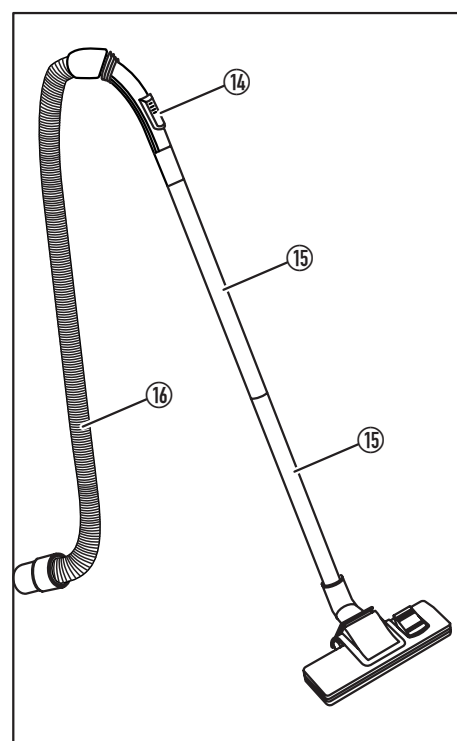
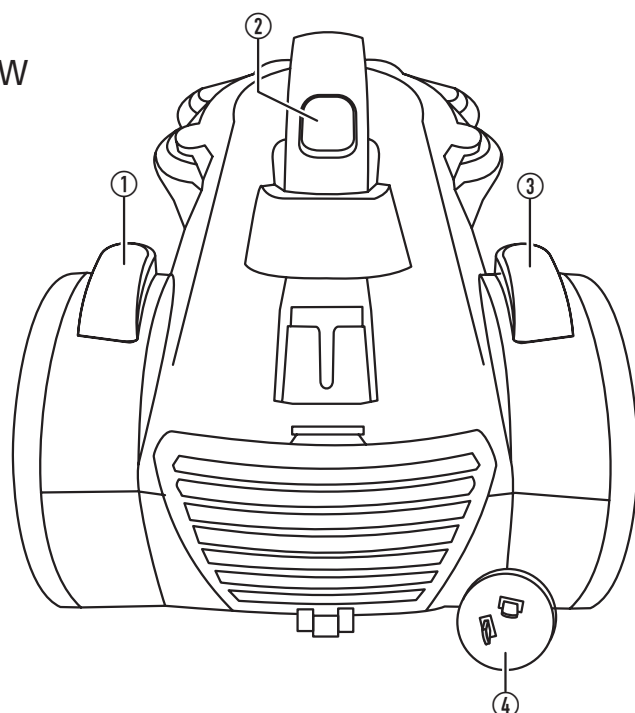

FRONT VIEW

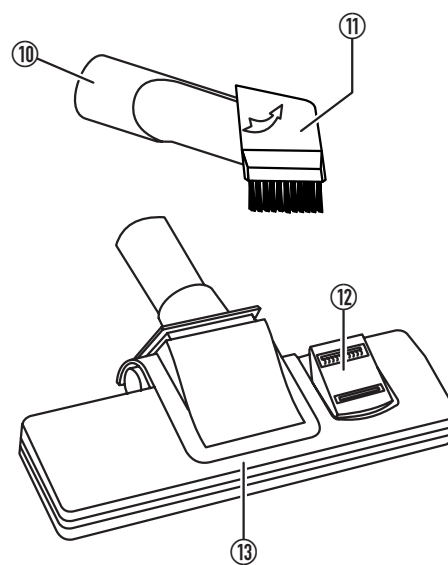
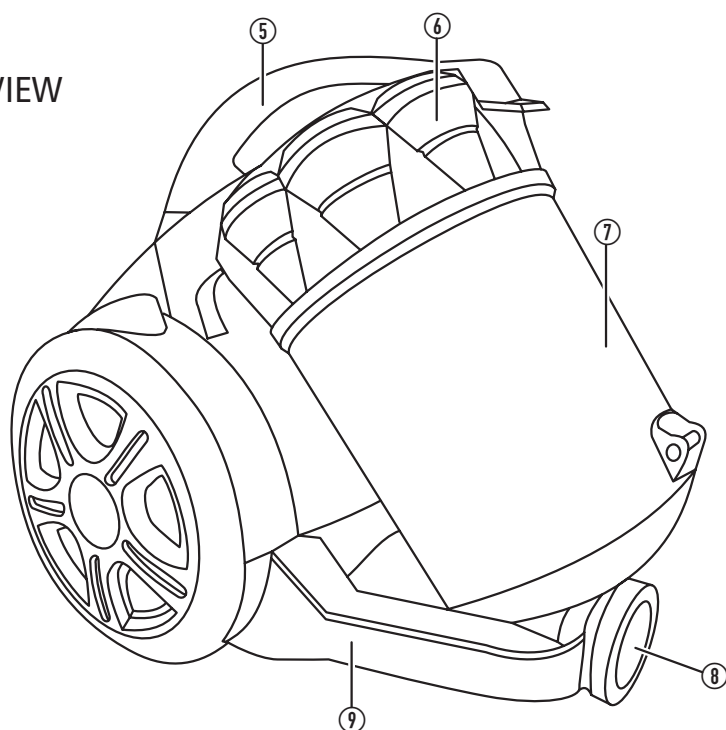

1. On/Off switch
2. Dust container release button
3. Power cable rewind button
4. Power cord
5. Handle
6. Dust container lid
7. Dust container
8. Air inlet

9. Cleaner body
10. Nozzle attachment
11. Rotating brush
12. Brush selector
13. Floor cleaner attachment
14. Suction control
15. Extension tubes
16. Hose

CLEANING OPTIONS

Floor cleaning

The floor-cleaner attachment should be fitted with the extension tubes for regular cleaning of flooring. The attachment includes a brush for wood or tiled flooring that can be retracted when cleaning carpets and rugs.

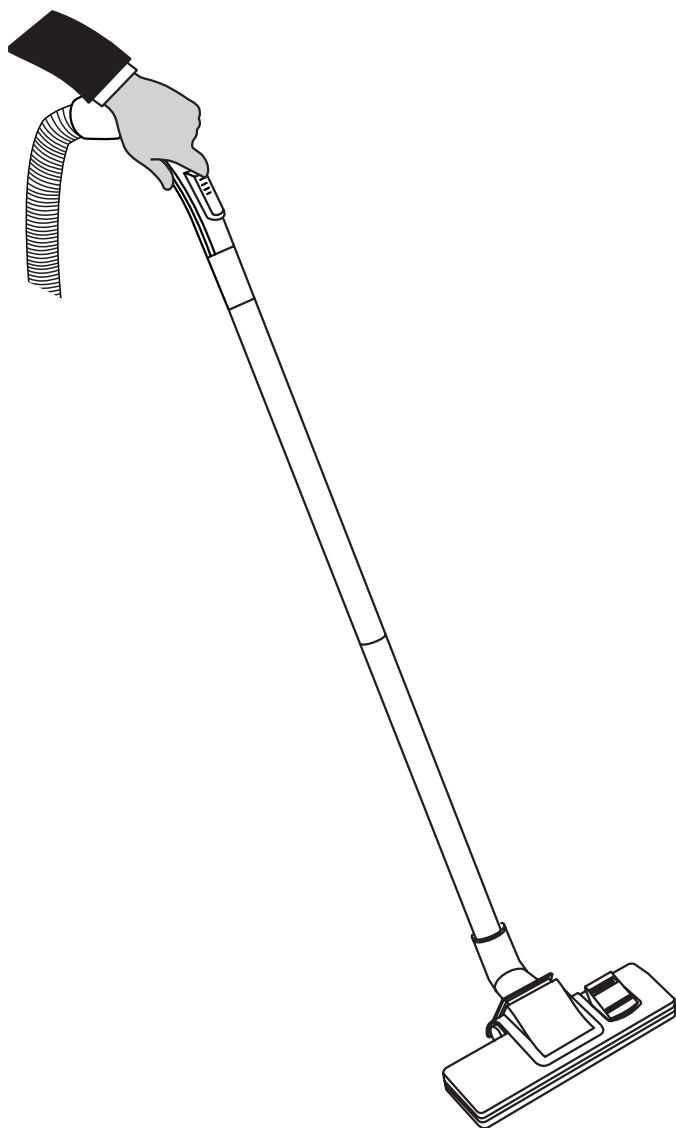

Nozzle/brush tool

The nozzle/brush tool includes a rotating end that will switch between a plain nozzle or a small brush.

- Rotate the brush section to switch between the two functions.

When using the nozzle the suction is more concentrated and can be used around floor edges and for vacuuming furniture etc.

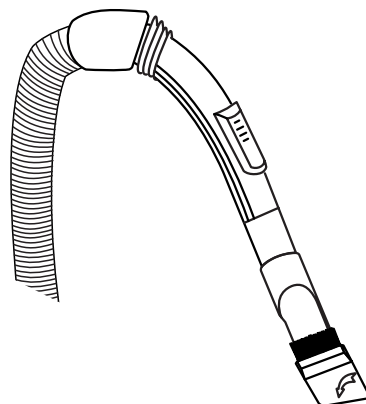

When set with the small brush the tool can be used to brush in difficult to reach areas.

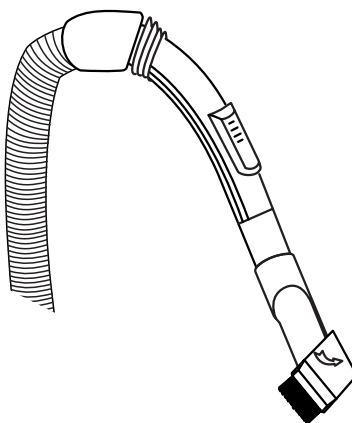

Add the extension tubes to reach higher places.

ASSEMBLING THE CLEANER

Switch off the cleaner when fitting/removing the hose, extension tubes or attachments.

Fitting the hose

NOTE: It is always necessary to fit the hose when using the cleaner.

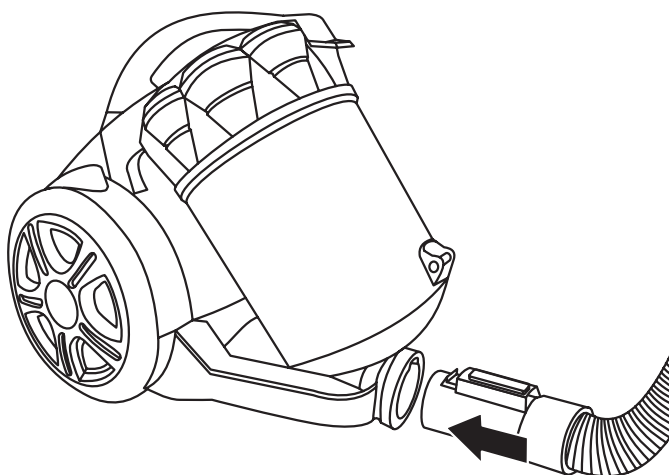

- Hold the coupler end of the hose with the catch uppermost.
- Push the hose coupler into the air inlet on the front of the vacuum cleaner until it locks in place.

Removing the hose

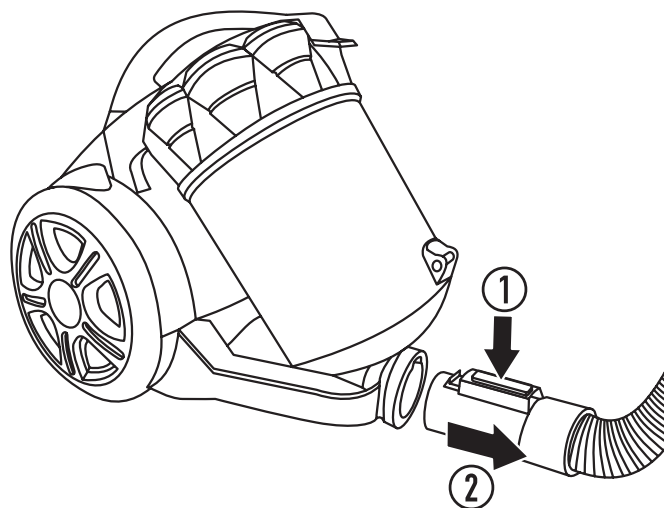

1. Hold down the catch on the hose coupler.
2. Pull the coupler out of the air inlet.

Fitting the extension tubes

Fit the extension tubes when cleaning floors or to extend the reach of the attachments when cleaning curtains etc.

You can fit one or both extension tubes.

- Push one or both extension tubes onto the end of the hose as required.

The extension tubes are the same size so are interchangeable.

Fitting the attachments

The attachments are a push fit on the hose or extension tubes, there is no catch to retain them.

- Push the attachment you want to use onto the end of the hose/tube.

Removing the tubes or attachments

- Pull the tubes or attachments apart when you have finished using them.

There are no catches to release.

OPERATION

Preparation for use

- Check that the power cable is disconnected.
- Empty the dust container if necessary.
- Fit the attachment you want to use and the extension tubes (if required).
- Grip the power plug and gently pull the power cable out of the back of the cleaner.

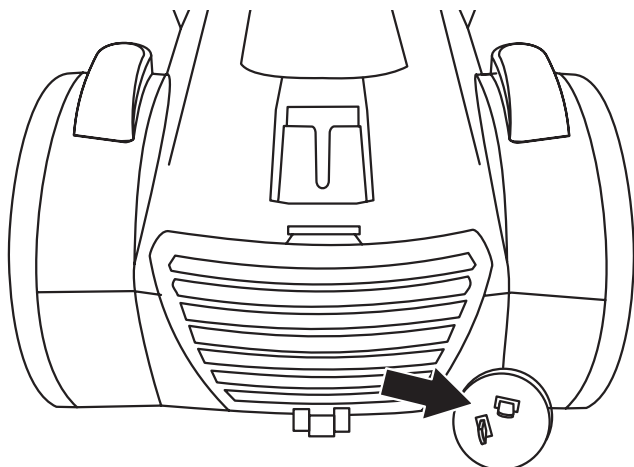

- Extend the cord as far as you need.
A yellow ring on the cable indicates the ideal length. The red ring indicates the maximum safe length. Never pull the cable beyond this point or damage may occur.
- Connect the power to a mains outlet in reach of the whole area you want to clean. Check that the cable will cover the area without snagging, pulling or causing a trip hazard.

Using the cleaner

- Close the suction control on the handle.
Set for full suction.
- Press the On/Off switch.
The cleaner will switch on.
- If you are using the floor-cleaner, set the brush selector for carpet or hard floors and move the cleaner back and forth over the area you want to clean.

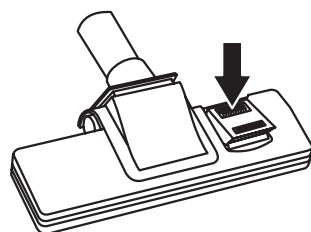

Hard floors

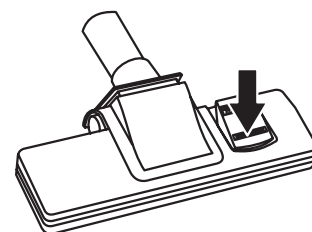

Carpet

- If you are using the nozzle/brush, carefully apply the tip of the nozzle or brush to the areas you want to clean.
The suction will be high at the tip of the nozzle or brush. If the cleaner inadvertently sucks in curtains or soft furnishing material, switch it off immediately and remove it carefully.

Suction control

Suction can be controlled by the slider on the handle of the hose.

- Close the slider fully for maximum suction or slide it open to reduce suction.

OPERATION

Cautions when cleaning

- Take extra care when using the cleaner on stairs.
- Never operate the cleaner with the filters removed.
- Never pull the cleaner around by the power cable.
- Take care not to trip on the power cable or hose. Watch out for other people and pets when you are cleaning.
- If you suspect there is a blockage in the hose or an attachment, switch off immediately.
- If the cleaner cuts out while cleaning the motor may have overheated. If this happens, empty the dust container, check and clear any blockages, then refer to the 'cleaning and maintenance' section and clean all filters.

Blockages

- If you suspect there is a blockage, switch off the cleaner immediately to avoid damage.
- If one of the attachments is blocked, disconnect the power cord and remove the attachment.
- Carefully use a screwdriver or similar tool to clear the blockage.

After use

- Press the On/Off switch to switch the cleaner off.
- Disconnect the power cable. Holding the plug, press the rewind button to wind the cable onto the storage reel.
- Follow the instructions in the Cleaning and Maintenance section to check if the dust container should be emptied and clean the filters if necessary.

Storage

Always store the cleaner and all attachments in a dry, cool place out of reach of children and pets.

The slot on the back of the cleaner can be used to park the floor cleaner attachment set up with extension tubes and hose fitted when not in use.

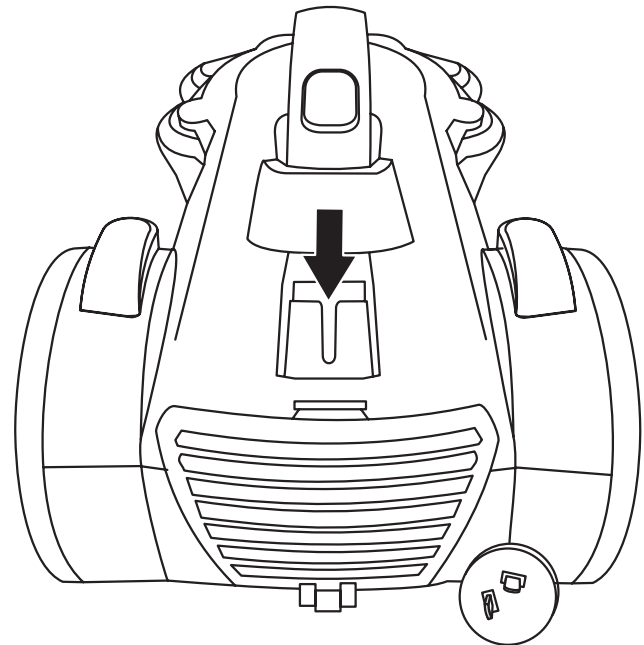

CLEANING AND MAINTENANCE

Always disconnect the cleaner from mains power before any cleaning operation.

Never clean any of the cleaner components with scourers, abrasive pads or chemicals.

Emptying the dust container

NOTE: For best cleaning performance, always empty the dust container when the dust level reaches the MAX mark, marked on the side, and clean the filters regularly. Never let the container fill over the MAX level (arrowed below).

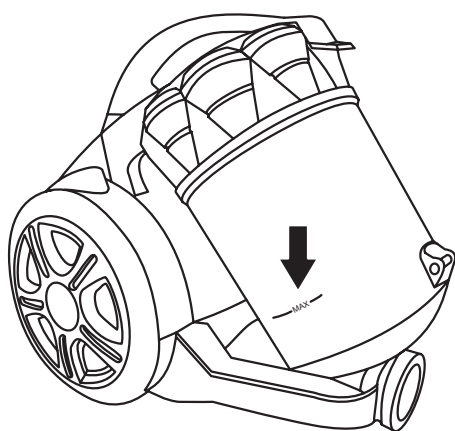

- Remove the hose from the cleaner.

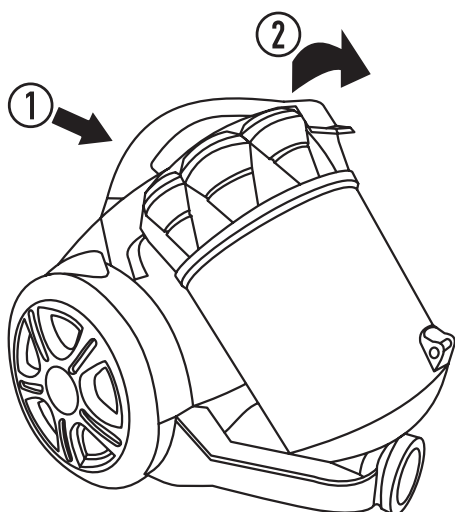

1. Press the dust container release button.
2. Lift the dust container off the body of the cleaner with the container handle.

- Hold the dust container over a bin or bag.
- Gently pull the tab at the bottom of the dust container to unlock the base.

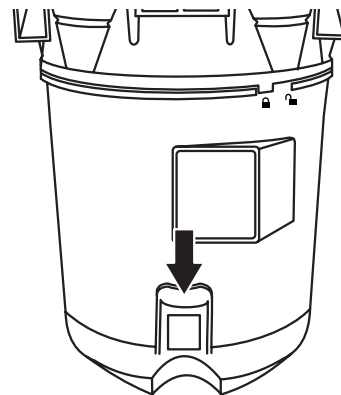

The base of the container will open, dropping the dust into the bin.

- Press the cover back into place.
The cover will latch closed.

Re-fitting the dust container

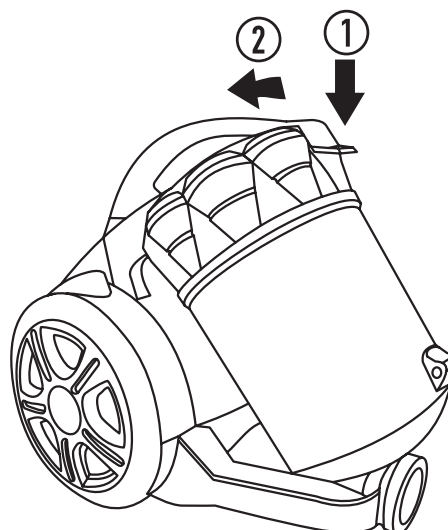

1. Place the dust container back in position on the cleaner
2. Push the top of the container back firmly.

The latch will click and the container will lock in place. The cleaner is ready for use.

CAUTION: Ensure that the dust container has locked fully in place before attempting to lift the vacuum cleaner by the handle.

CLEANING AND MAINTENANCE

Filters

IMPORTANT: There are three filters in the cleaner that require regular cleaning. If filter cleaning is neglected, suction performance will drop and the cleaner will be damaged.

The filters are -

- Main filter
- Filter grille
- Air outlet filter

The main filter should be cleaned each time the dust container is emptied.

The filter grille and air outlet filter can be cleaned twice a year in normal use. Clean it more regularly when the cleaner is used heavily or when used in a particularly dusty environment.

NOTE: Never wash the filters in a washing machine or use a hairdryer to dry them.

Removing the main filter

The main filter is inside the top of the dust container.

- Remove and empty the dust container as described in the previous section.
- Gently unclip the top lid of the dust container.



1. Open the lid fully.

The main filter is directly under the lid.

2. Lift out the main filter.

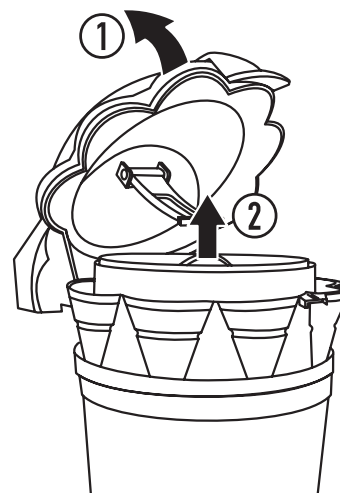

CLEANING AND MAINTENANCE

Cleaning the main filter

- The main filter consists of two parts - the filter frame including a fabric filter and a foam filter.

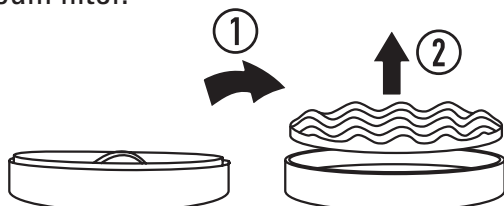

1. Invert the filter holder.
 2. Lift out the foam filter.
- Wash both components in warm, running water until the water runs clean. Move the filter components to a location where they can drain and dry thoroughly.

Re-assembling the main filter

When completely dry, re-assemble the foam filter into the filter frame.

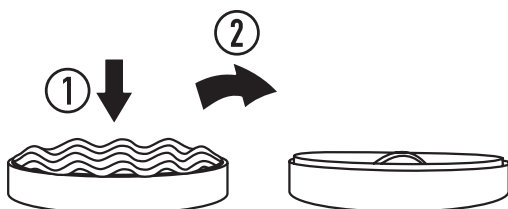

1. Fit the foam filter into the filter frame with the wavy side upwards.
2. Invert the filter.
3. Place the filter in the top of the dust container.
4. Close the dust container lid. Press the catch down until it clicks.

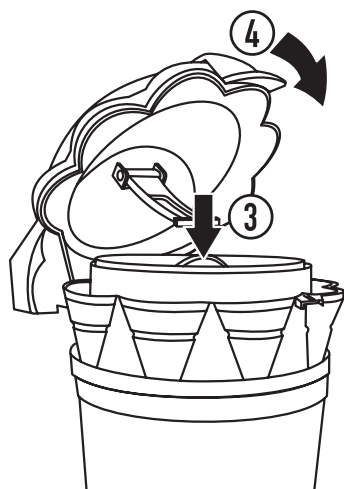

Removing the filter grille

The filter grille is inside the body of the dust container.

- Remove and empty the dust container.
- Remove the main filter from the dust container as described in the previous section.

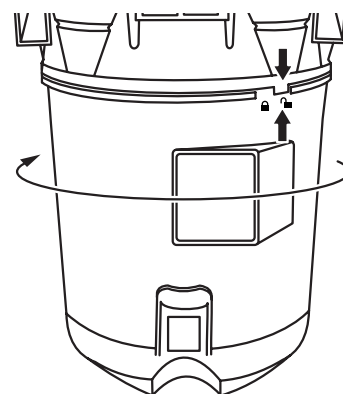

- Holding the top of the dust container, twist the body as shown to align the pointer with the unlock indicator (arrowed).
- The top can now be removed from the dust container.

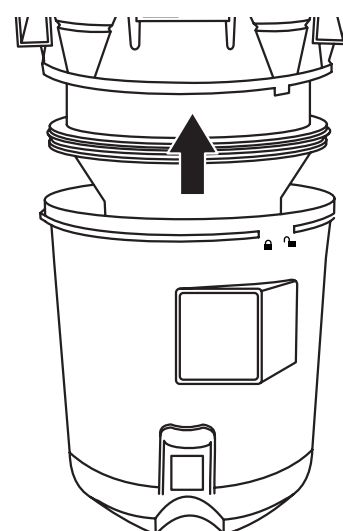

- Wash all components of the container thoroughly in warm, running water.

CLEANING AND MAINTENANCE

Re-assembling the filter grille

When all components have completely dried, fit the top back into the container.

- Align the pointer with the unlock indicator, then fit the container lid.

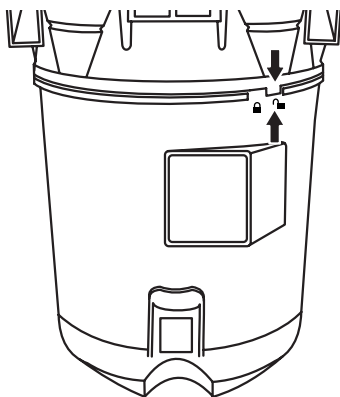

- Holding the top of the container, twist the body as shown until the pointer lines up with the lock indicator.

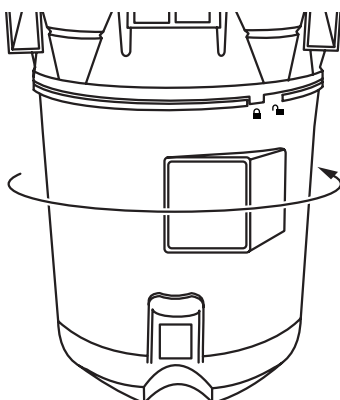

Checking the air outlet filter

The air outlet filter is a foam filter, located in a holder at the back of the main body of the cleaner.

- Press the tab at the top of the filter holder.

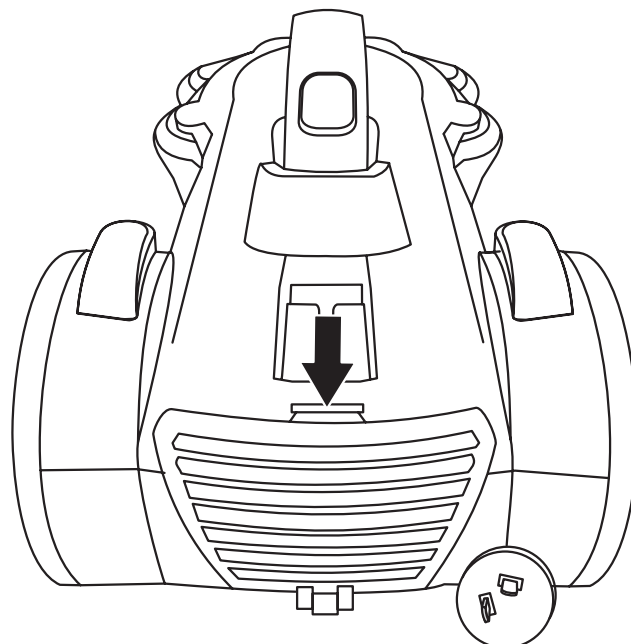

- Lift out the filter holder.
- Lift the foam filter out of the filter holder.
- Wash the foam filter and holder in warm, running water until the water runs clean.
- Move the filter to a location where it can drain and dry thoroughly.
- When completely dry, place the foam filter into the filter holder.
- Fit the filter holder into the main body of the cleaner by engaging the clips at the bottom of the holder then clipping the top into place.

TROUBLESHOOTING

No power	Check that mains power is connected and the cleaner is switched on.
Reduced suction	Switch off the cleaner. Check if the dust container is fitted correctly and is empty of dust. Check if the filters are clean.
	If the problem persists, check if there is a blockage in the attachments or hose.
Dust clouds from the cleaner	Switch off the cleaner. Check if the dust container is fitted correctly and is empty of dust.
Cleaner cuts out in use	The motor may have overheated. Switch off and unplug the cleaner and leave it to stand for 1 hour before using it again. If the cleaner overheats, it is most likely to be due to blocked filters. Always check all the filters if the cleaner has cut out in use.
The dust container lid will not close	Check that the main filter is fitted and is in the correct position. The lid will not close if the main filter is not fitted.
Cord retraction fails	The cord may have tangled as it retracted. Hold down the cord rewind button, pull out a length of cord, then let it retract again slowly. Repeat a few times if necessary.

SPECIFICATIONS

Power supply230 - 240V~, 50Hz

Power consumption..... 1200 W

 Class II double insulated.

E285

WARRANTY

1. Our goods come with guarantees that cannot be excluded under the Australian Consumer Law. You are entitled to a replacement or refund for a major failure and for compensation for any other reasonably foreseeable loss or damage. You are also entitled to have the goods repaired or replaced if the goods fail to be of acceptable quality and the failure does not amount to a major failure. Where a failure does not amount to a major failure, BIG W is entitled to choose between providing you with a repair, replacement or refund. To obtain compensation, you would need to provide documentary evidence of the loss or damage suffered, and documentary evidence that such loss or damage was a reasonably foreseeable consequence of a failure by BIG W to comply with a consumer guarantee under the Australian Consumer Law. Such evidence may include photographs, statutory declarations, receipts or reports (eg from your doctor), depending on the loss or damage.
2. In addition to all rights and remedies to which you may be entitled under the Competition and Consumer Act 2010 (Commonwealth) and any other relevant legislation, the manufacturer warrants this product to be free from defects in materials or workmanship for a period of 24 months from the date of purchase.
3. In order to claim under this warranty you will need to bring the product to any BIG W store, along with proof of purchase (typically this will be a receipt). Any cost incurred by you in bringing the product to the service desk will be borne by you. We will then, at our option, either repair or replace the product, or refund your money and take back the product – in accordance with our Returns Policy, a copy of which is available at our return desk
4. Our liability under this manufacturer's warranty is subject to us being satisfied that a defect was caused by defective workmanship or materials, and was not caused by or substantially contributed to by other factors, or circumstances beyond our control, including (but not limited to) defective installation, maintenance or repair, alteration or modification of the product in a manner not recommended by the manufacturers or any neglect, misuse or excessive use.
5. The benefits conferred by this manufacturer's warranty are in addition to all rights and remedies conveyed by the Competition and Consumer Act 2010 (Commonwealth), and any other statutory rights to which you may already be entitled, and this warranty does not exclude, restrict or modify any such rights or remedies that are implied by law.
6. This warranty is provided by BIG W of 1 Woolworths Way, Bella Vista NSW 2153, Phone: 1300 244 999.

contempoTM

Made for Big W
1 Woolworths Way
Bella Vista NSW
2153 Australia

Made in China

CONTEMPO BW-1602 VO.2