

contempo™

Owner's Handbook

SWS-801

Garment Steamer

CONTENTS

IMPORTANT SAFETY INSTRUCTIONS	1
CARE AND CLEANING	3
Before cleaning	3
Garment hanger, telescopic column and steam head.....	3
Water boiler	3
De-scaling	3
CONTROLS AND FEATURES	4
UNPACKING	5
HOW IT WORKS	5
BEFORE YOU START	5
Location for garment steaming.....	5
Prepare clothing to be steamed	5
ASSEMBLY	6
Garment hanger	6
Telescopic column.....	6
Fitting the garment hanger	6
Hose	6
OPERATION	7
Fitting a steaming attachment	7
Filling the tank.....	7
Preparing to steam garments	7
Steaming a garment	8
Using the pants press.....	8
Using the hand-held steaming board	9
AFTER USE	9
TROUBLESHOOTING	9
The appliance is switched on but there is no steam	9
No steam is produced	9
SPECIFICATIONS.....	9
WARRANTY.....	10

Please keep your sales docket, including cash register receipt, in a safe place as the docket will prove the commencement of the period of this warranty. If you wish to make a claim specifically under this manufacturer's warranty, you will be required to provide proof of purchase, preferably your sales docket.

IMPORTANT SAFETY INSTRUCTIONS

Please read these instructions carefully before using the appliance for the first time.

- Always use the appliance from a power outlet of the same voltage (A.C. only) marked on the appliance.
- This appliance includes an earthed pin and must be used with a power outlet with earthed connection.
- Always turn the power off at the power outlet before you insert or remove a plug. Remove by grasping the plug - do not pull on the cord.
- Turn the power off and remove the plug when the appliance is not in use and before filling or emptying the water tank.
- Do not use the appliance with an extension power board.
- If the supply cord is damaged, it must be replaced by the manufacturer or its service agent or a similarly qualified person in order to avoid a hazard.
- The appliance is not to be used if it has been dropped, if there are visible signs of damage or if it is leaking.
- The appliance shall not be operated by means of an external timer or separate remote control system.
- Do not let the power cord of the appliance hang over the edge of a table or bench top or touch any hot surface.
- Do not place the appliance on or near a hot gas flame, electric element or on a heated oven. Do not place on top of any other appliance.
- For additional protection, it is recommended to use the appliance with a residual current device (safety switch) with a tripping current not exceeding 30mA in the power socket which supplies power to the appliance.
- Allow the appliance to cool completely before storing.
- Children should be supervised to ensure that they do not play with the appliance. Close supervision is necessary when the appliance is used near children.

IMPORTANT SAFETY INSTRUCTIONS

- Do not immerse the appliance in water or any other liquid.
- This appliance is not suitable for use by persons (including children) who have limited physical, sensory or mental abilities, or by persons who have a lack of experience and/or lack of knowledge unless they are supervised by a person in charge for their security or receive instructions by them on how to use the appliance.
- The appliance must not be left unattended while it is connected to the supply mains.
- Do not use the appliance for any purpose other than its intended use.
- The appliance is for household use only and should not be used outdoors.
- Do not operate any appliance with a damaged cord or plug or after the appliance malfunctions or is dropped or damaged in any manner. Return the appliance to the nearest authorised service facility for examination, repair or electrical or mechanical adjustment.
- Ensure that the garment steamer has been fully and correctly assembled before use.
- Never over-fill the water tank with more than the maximum 1.7L capacity.
- Ensure there is adequate room to operate the appliance.
- Always hold the steamer head by the handle. Never touch the hose while operational.
- Never operate without fitting the steam hose or remove the steam hose while in use.
- Keeps hands and other body parts away from the steam outlet.
- Always hold the steamer head so that the steam outlet is directed away from you, other people, pets and other electrical appliances.
- Do not use hands to support or hold garments while steaming them. Risk of burns.
- Never use the appliance on clothes that are being worn. Clothes must always hang on the garment holder during steaming.
- Keep the appliance well away from surfaces and objects that can be damaged by heat.
- The appliance must stand on a stable floor during operation. Never use the appliance on a table or other raised surface.
- Never place the steamer head on the ground.
- Never remove the steam hose when the appliance is hot. Allow the appliance to cool first.
- Never fill the water tank with hot water.
- Never over-fill the water tank.
- Always disconnect the power supply and empty the water tank before moving the appliance, never move or drag it when it is operational or when there is water in the tank.
- Do not use the appliance if water is leaking from it.
- Do not use this appliance for professional laundry.
- Do not use the product near combustible material.
- When operating, never stand the appliance on a surface that may be damaged by steam, damp or drips from the steaming operation.
- Do not use this appliance for any purpose not covered by the instructions.
- Care should be taken when using the appliance due to the emission of steam.
- Unplug the appliance during filling and cleaning.

CARE AND CLEANING

CAUTION: Never immerse any part of the appliance or cable in water during cleaning.

- Disconnect the appliance from mains power and ensure it has completely cooled before cleaning it.

This will take approximately 30 minutes.

Never clean any part of the appliance with scourers, abrasive pads or chemicals.

Before cleaning

- Remove the water tank, invert it and carry it to a sink. Unscrew and remove the stopper then empty the tank.
- Unscrew and remove the steam hose.
- Lift off the garment hanger.
- Unlock the locking collar for the telescopic column and remove the column.
- Carry the appliance to a sink and invert it to empty any remaining water.

The water will empty through the steam hose connection.

Garment hanger, telescopic column and steam head

- Wipe clean with a slightly damp cloth.
- Allow to dry thoroughly before use.

Water boiler

The water boiler can be cleaned if required.

- After emptying the appliance, carry it to a sink and remove the boiler plug from the base.

Remaining water may flow out.

The inner surfaces of the boiler can now be cleaned with a small brush through the plug opening.

- Allow the boiler to dry fully before re-fitting the plug.

De-scaling

If the appliance is in regular use in an area with a hard water supply it is advisable to de-scale it regularly, preferably on a monthly basis.

- Follow the instructions in the 'Before cleaning' section in the previous column to prepare the appliance.
- Mix 150ml water with 150ml white vinegar in a jug.
- Pour the solution slowly into the hose connector.
- Wait for 40 minutes.
- Drain the solution out of the appliance into a sink by removing the boiler plug underneath the appliance body.
- Drain any remaining solution out of the hose connector by tilting the unit over the sink.
- Pour clean water into the hose connector to rinse out the boiler. Repeat until the vinegar smell has gone.
- Reassemble the appliance.

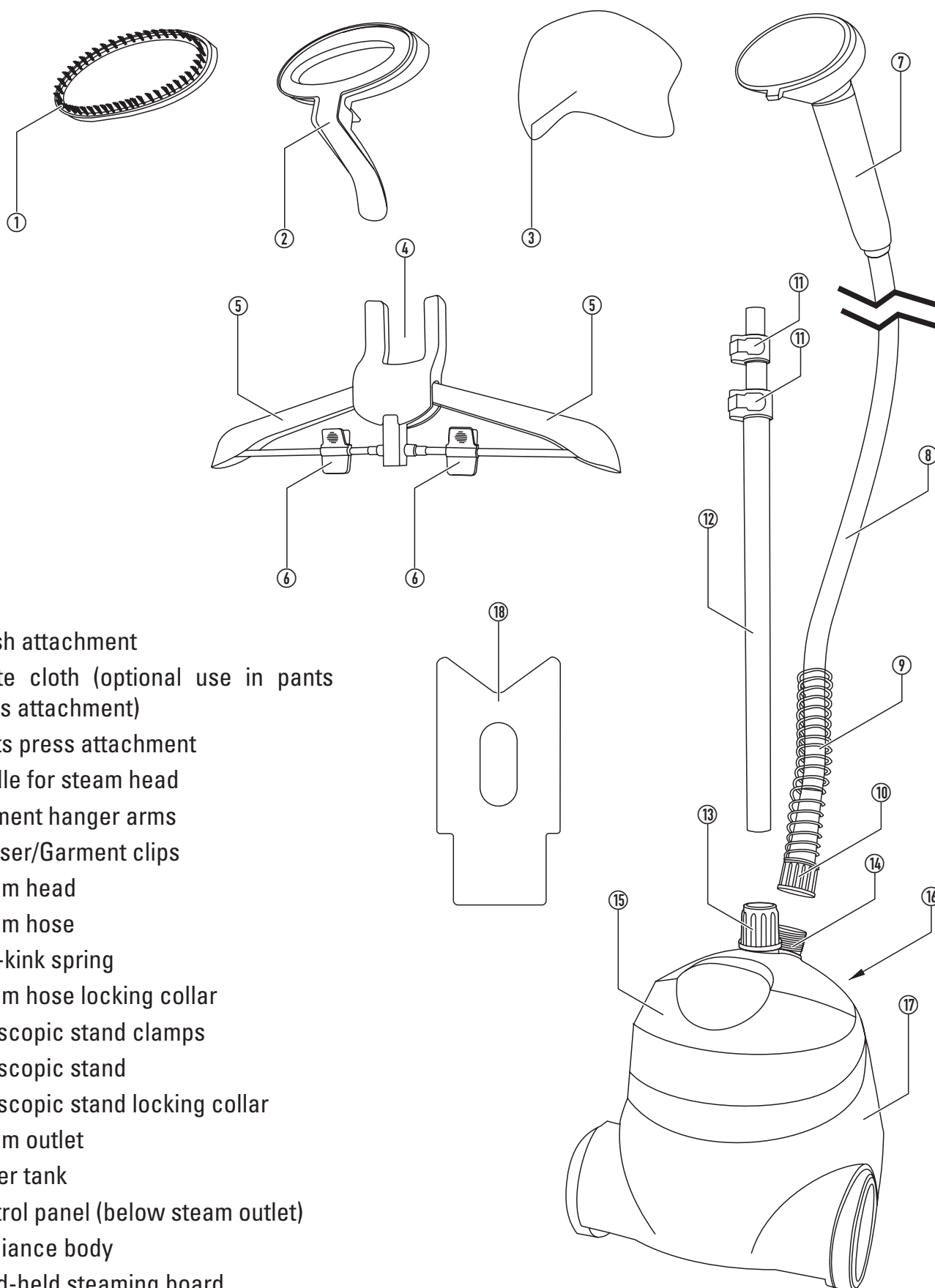
CONTROLS AND FEATURES

1. Brush attachment
2. White cloth (optional use in pants press attachment)
3. Pants press attachment
4. Cradle for steam head
5. Garment hanger arms
6. Trouser/Garment clips
7. Steam head
8. Steam hose
9. Anti-kink spring
10. Steam hose locking collar
11. Telescopic stand clamps
12. Telescopic stand
13. Telescopic stand locking collar
14. Steam outlet
15. Water tank
16. Control panel (below steam outlet)
17. Appliance body
18. Hand-held steaming board

UNPACKING

Unpack the garment steamer from the carton. Retain the carton and packing for future use. If you have to dispose of the carton and packing, please do so responsibly.

The carton should contain -

- 1 x Steamer body with tank.
- 1 x Telescopic stand.
- 1 x Garment hanger.
- 1 x Hose with steam head.
- 1 x Brush attachment.
- 1 x Pad attachment with pad.
- 1 x Hand-held steaming board.
- 1 x Owner's handbook.

HOW IT WORKS

The garment steamer is a quick and easy way to remove wrinkles and creases from your garments. It works by heating water to form steam which can then be applied to hanging clothing through a hand-held nozzle, the steam head.

BEFORE YOU START

Location for garment steaming

Always locate the garment steamer on a flat, stable floor that is not sensitive to steam, damp or drips from the steaming operation. Ensure that there is enough space around the appliance for you to reach without stretching. Ensure that the cable can easily reach a power outlet and that the cable will not be a hazard to people, children or pets.

Never steam clothes on the body.

Always keep children and pets away from the area when you are steaming clothes.

Prepare clothing to be steamed

Sort the clothing that you want to steam.

Ensure that the fabrics are suitable for steaming. As a general rule, most cottons, silks and polyesters should be suitable for steaming. Some materials including waxed jackets, suede, pure wool, velvet, corduroy and materials that may melt such as plastic are not suitable for steaming.

To avoid damage to printed garments or to embellishments, turn the garment inside out before steaming.

Always check fabric care labels for advice prior to steaming. If in doubt, carefully test the steamer on a small, inconspicuous area of the fabric before steaming the entire garment.

You may want to hang garments on clothes hangers before steaming to remove some initial creases.

Use a fabric brush to remove any lint from garments before steaming.

ASSEMBLY

- Following the instructions in the previous section, locate the main body of the appliance where it will be used.

Garment hanger

- Raise the arms of the garment hanger and clip the two stays into place.
- Use the lock sleeves to lock the stays.

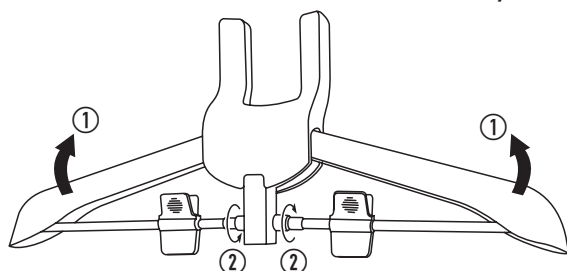

The garment hanger is now assembled, ready to use.

Telescopic column

- Unscrew the column locking collar.

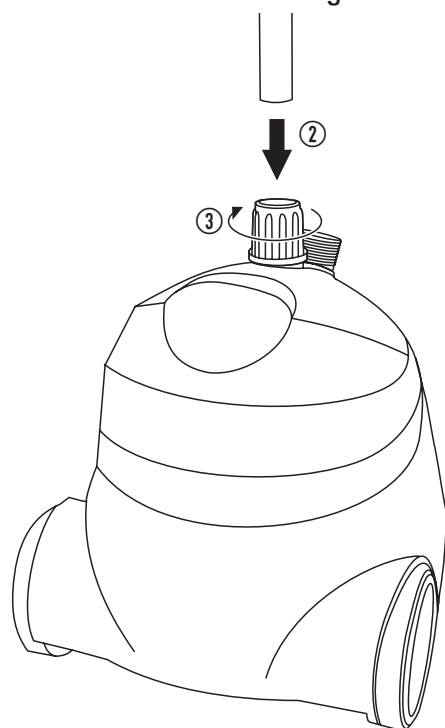

- Push the telescopic column into the locking collar.
- Tighten the locking collar and check that the telescopic column is fully fitted and stable.
- Undo the two latches on the telescopic column and extend it fully.
- Close the latches to fix it in the extended position.

Fitting the garment hanger

- Fit the assembled garment hanger onto the top of the telescopic column.

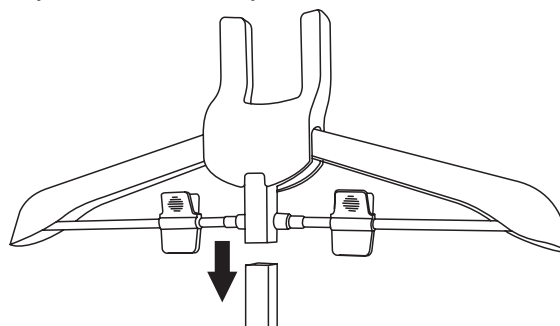

Hose

- Screw the locking collar at the end of the steam hose onto the steam outlet.

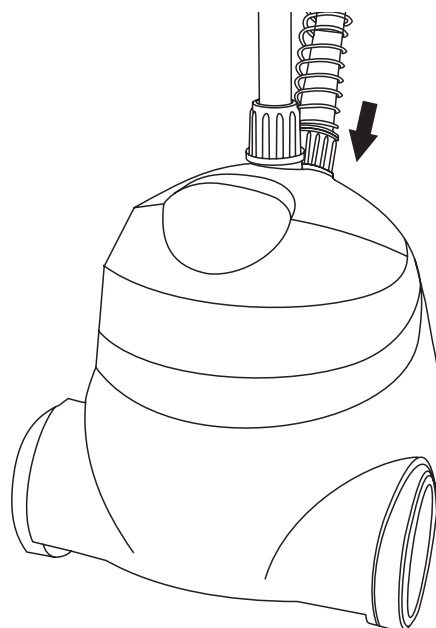

- Ensure that the anti-kink spring is positioned at the bottom end of the hose as shown.
- Place the steam head into its rest position in the cradle on the garment hanger (arrowed).

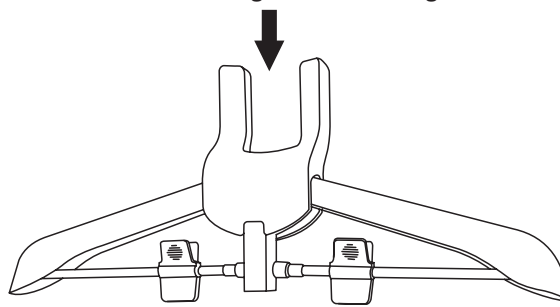

Assembly is complete. The garment steamer is ready to use.

OPERATION

Fitting a steaming attachment

- Clip a steaming attachment to the face of the steam head.

Choose from the brush attachment or the pants press attachment.

The brush may be useful for thicker fabrics or for stubborn wrinkles.

The pants press attachment will give a 'crease' finish to the edge of pants similar to an iron.

Filling the tank

- Lift the tank off the steamer body.
- Invert the tank and unscrew the stopper.
- Fill the tank with cold water up to its maximum capacity of 1.7L. Do not over-fill.

CAUTION: Do not stand the tank on its base when it contains water. This will open the valve and release water.

Use de-ionised/distilled water where possible to reduce the possibility of scale building up.

Do not add detergents, fragrances or perfumes to the water in the tank. Additives may damage the appliance.

- Place the tank on the body of the appliance.

Preparing to steam garments

CAUTION: Do not use the device for steaming garments in a horizontal position, always hold the steam head pointing upwards – condensed steam will return to the water container and water dripping from the steam head is reduced.

CAUTION: Do not use hands to support or hold garments while steaming them. Risk of burns.

Before starting to steam a garment, straighten it on the hanger as best as possible.

Depending on the type of garment to be ironed, use vertical or horizontal strokes.

Thick fabrics may require more steaming time.

Be sure to follow any garment instructions to keep the steam head a safe distance from delicate fabrics etc.

Delicate garments may benefit from being turned inside out when steaming.

- Connect the power cord to a convenient mains outlet.
- Place the steam head in the cradle on the garment hanger.
- Set the power switch to the low power (1) or high power (2) setting.

The low power setting may be more suitable for delicates.

The power indicator will light and the water will start to heat.

After a minute or so steam will emit from the steam head.

The appliance is now ready for use.

OPERATION

Steaming a garment

- Place a garment on the garment hanger or hang it from the trouser/garment clips.
- Smooth the garment with your hands before applying steam.

- Steam in smooth strokes to apply steam to the hanging garments from the steam head.

Use vertical or horizontal strokes as necessary. Upward, vertical strokes are likely to work best for most garments.

- Once you finish steaming each garment, move it to a clear area and hang to dry.

This should take around five to ten minutes. Ensure all garments are completely dry before storage.

Return the steam head to rest on the cradle on the garment hanger when changing garments for steaming etc.

- Hang the next garment and repeat.

The water tank should supply enough steam for approximately one hour's steaming.

Using the pants press

The pants press attachment can be used to press pants with a crease line similar to an iron.

1. Fit the attachment to the steam head.

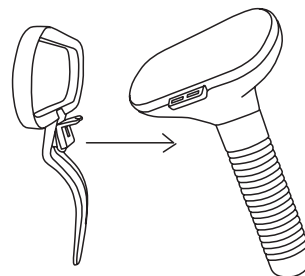

2. As an option, the white cloth (supplied) can be clipped into the press to avoid water/steam/high temperatures having direct contact with clothes.

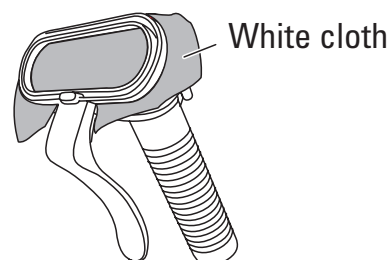

3. Clip the pants press to the edge of the pants leg and draw it along the edge to form a crease.

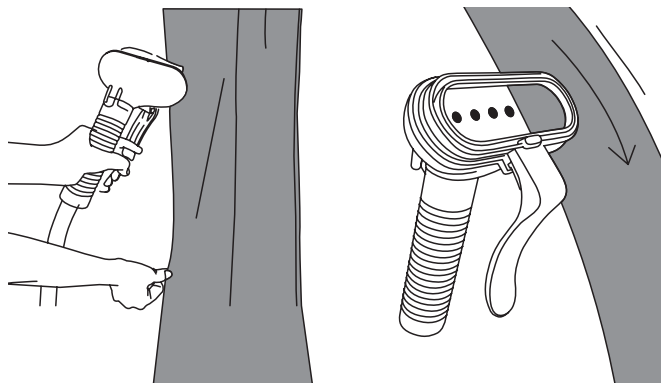

OPERATION

Using the hand-held steaming board

The hand-held steaming board can be used to back up fabrics when steaming.

CAUTION: Keep hands away from the steam nozzle at all times to avoid scalding.

Collars

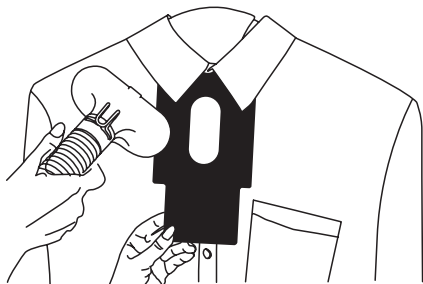

Pockets

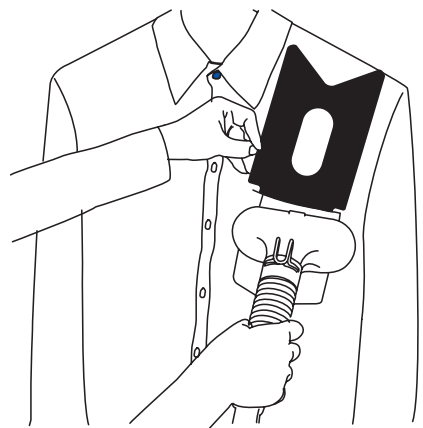

Sleeves and corners

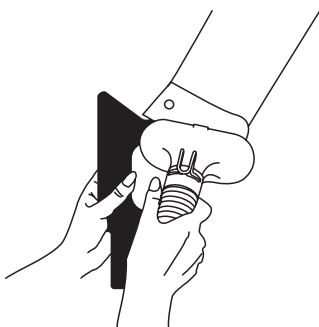

AFTER USE

- Disconnect mains power and allow the appliance to cool completely.
- Remove any accessories.
- Clean the appliance as directed in the 'Care and Cleaning' section.
- Prepare the appliance for storage.

The appliance can be dismantled before storage or can be left assembled. If so, unlock the telescopic column and collapse it fully to reduce the risk of the appliance toppling and causing damage or injury.

- Coil the power cord loosely during storage. Do not wind the power cord around the appliance body.
- Store the appliance in a cool, dry place away from children and pets.

TROUBLESHOOTING

The appliance is switched on but there is no steam

- There may be no water in the tank.
- The water tank may be empty.
Switch off and allow the appliance to cool. Re-fill if necessary.
- The power cord is not plugged in correctly.
Check that the power cord has been fully inserted into the mains outlet.

No steam is produced

- The steam hose may be kinked.
Check that the steam head is in the rest position on the garment hanger cradle and that the anti-kink spring is positioned at the bottom of the steam hose.

SPECIFICATIONS

Power supply 220 - 240 V~, 50 Hz

Power consumption..... 1800 W

IMPORTANT: THIS APPLIANCE MUST BE EARTHED.



WARRANTY

1. Our goods come with guarantees that cannot be excluded under the Australian Consumer Law. You are entitled to a replacement or refund for a major failure and for compensation for any other reasonably foreseeable loss or damage. You are also entitled to have the goods repaired or replaced if the goods fail to be of acceptable quality and the failure does not amount to a major failure. Where a failure does not amount to a major failure, BIG W is entitled to choose between providing you with a repair, replacement or refund. To obtain compensation, you would need to provide documentary evidence of the loss or damage suffered, and documentary evidence that such loss or damage was a reasonably foreseeable consequence of a failure by BIG W to comply with a consumer guarantee under the Australian Consumer Law. Such evidence may include photographs, statutory declarations, receipts or reports (eg from your doctor), depending on the loss or damage.
2. In addition to all rights and remedies to which you may be entitled under the Competition and Consumer Act 2010 (Commonwealth) and any other relevant legislation, the manufacturer warrants this product to be free from defects in materials or workmanship for a period of 24 months from the date of purchase.
3. In order to claim under this warranty you will need to bring the product to any BIG W store, along with proof of purchase (typically this will be a receipt). Any cost incurred by you in bringing the product to the service desk will be borne by you. We will then, at our option, either repair or replace the product, or refund your money and take back the product – in accordance with our Returns Policy, a copy of which is available at our return desk.
4. Our liability under this manufacturer's warranty is subject to us being satisfied that a defect was caused by defective workmanship or materials, and was not caused by or substantially contributed to by other factors, or circumstances beyond our control, including (but not limited to) defective installation, maintenance or repair, alteration or modification of the product in a manner not recommended by the manufacturers or any neglect, misuse or excessive use.
5. The benefits conferred by this manufacturer's warranty are in addition to all rights and remedies conveyed by the Competition and Consumer Act 2010 (Commonwealth), and any other statutory rights to which you may already be entitled, and this warranty does not exclude, restrict or modify any such rights or remedies that are implied by law.
6. This warranty is provided by BIG W of 1 Woolworths Way, Bella Vista NSW 2153, Phone: 1300 244 999.

contempo™

Made for Big W
1 Woolworths Way
Bella Vista NSW
2153 Australia

Made in China

CONTEMPO SWS-801 V0.6