



Owner's Handbook

JC3001BA-SA
Citrus Juicer

CONTENTS

IMPORTANT SAFETY INSTRUCTIONS	1
CARE AND CLEANING	5
UNPACKING.....	5
INTRODUCTION.....	5
CONTROLS AND FEATURES.....	6
PREPARATION	7
ASSEMBLY	7
OPERATION	8
TROUBLESHOOTING	9
SPECIFICATIONS.....	9
WARRANTY.....	10

Please keep your sales docket, including cash register receipt, in a safe place as the docket will prove the commencement of the period of this warranty. If you wish to make a claim specifically under this manufacturer's warranty, you will be required to provide proof of purchase, preferably your sales docket.

IMPORTANT SAFETY INSTRUCTIONS

Read all instructions before using and save for future reference

- Always use the appliance from a power outlet of the same voltage (A.C. only) marked on the appliance.
- Always turn the power off at the power outlet before you insert or remove a plug. Remove by grasping the plug - do not pull on the cord.
- Remove all accessories from the motor unit and remove the plug from the power outlet when the appliance is not in use, before putting on or removing parts and before cleaning.
- For additional protection, it is recommended to use the appliance with a residual current device (safety switch) with a tripping current not exceeding 30mA in the power socket which supplies power to the appliance.

IMPORTANT SAFETY INSTRUCTIONS

- If the supply cord is damaged, it must be replaced by the manufacturer or its service agent or a similarly qualified person in order to avoid a hazard.
- Do not let the power cord of the appliance hang over the edge of a table or bench top or touch any hot surface.
- Do not leave the power cord near the edge of a bench top where children may touch or pull it.
- The appliance shall not be operated by means of an external timer or separate remote control system.
- Do not place the appliance on or near a hot gas flame, electric element or on a heated oven. Do not place on top of any other appliance.
- Do not use the appliance near flammable material such as curtains, draperies and wallpaper.
- This appliance is for household use only and must not be used outdoors.
- Do not use the appliance for any purpose other than its intended use. Misuse of the appliance may cause injury.
- This appliance can be used by children aged from 8 years and above if they have been given supervision or instruction concerning use of the appliance in a safe way and if they understand the hazards involved. Cleaning and user maintenance shall not be made by children unless they are aged from 8 years and above and supervised. Keep the appliance and its cord out of reach of children aged less than 8 years.
- Children should be supervised to ensure they do not play with the appliance.

IMPORTANT SAFETY INSTRUCTIONS

- Always operate the appliance on a flat, level surface.
- Ensure a minimum of 20 cm space around the unit for air circulation.
- Do not immerse the motor unit into water or other liquids.
- After cleaning the jug and other accessories, ensure that they are completely dry before using again.
- Do not place any part of the juicer in a microwave or dishwasher.
- Do not leave the appliance unattended during use.
- Do not move the appliance while switched on.
- Do not use accessories or attachments not supplied with the appliance.
- Avoid contact with moving parts. Keep hands, hair, clothing, as well as spatulas and other utensils away from the appliance during operation to reduce the risk of injury to persons, and/or damage.
- The appliance must be operated for no more than 15 seconds repetitively - on for 15 seconds, then rest for 15 seconds. After 10 consecutive operational cycles it should be allowed to cool down for approximately 30 minutes before the next operation.
- The maximum capacity of the jug is 1.0 litre. Never allow the jug to overflow.
- Do not pour boiling or very hot water or other liquids into the jug during use or cleaning as it can cause damage to the unit.

IMPORTANT SAFETY INSTRUCTIONS

- **CAUTION:** Always operate the juicer with the jug fully assembled, attached to the motor body and with the lid locked in place.
- Do not attempt to defeat the lid locking mechanism to turn the appliance on.
- Do not run the appliance empty.
- Wait until rotating components stop moving before opening the jug.
- Always check the juicer jug to ensure there are no signs of cracks or damage prior to use.
- The juicer is intended to juice fresh fruit. Never use it with any other types of food.
- Always remove hard seeds and stones from fruit before juicing.
- Do not use the juicer to blend frozen ingredients. Always defrost fruit and vegetables completely before juicing.
- Switch off the appliance and disconnect from the supply before changing accessories or approaching parts that move in use.
- This appliance is intended to be used in household and similar applications such as :
 - Staff kitchen areas in shops, offices and other working environments;
 - Farm houses;
 - By clients in hotels, motels and other residential type environments;
 - Bed and breakfast type environments.
- **Warning:** Potential injury from misuse.

CARE AND CLEANING

- Disconnect the motor body from mains power before dismantling or cleaning the appliance.

Never clean any of the components with scourers, abrasive pads or chemicals.

The components of the juicer are not dishwasher safe. Never clean them in a dishwasher.

The motor body must never be immersed in water.

Dismantling the juicer

Dismantle the jug components immediately after use.

- Lift off the reamer(s). If necessary, separate the large reamer from the small reamer (see page 7).
- Unlock and remove the jug from the motor body.
- Lift off the drive spindle.

Cleaning the jug, strainer, reamers and lid

- Hand-wash these components in warm, soapy water then rinse thoroughly.
- Dry all components thoroughly before next use.

Motor body

- Wipe the motor body with a damp cloth and dry thoroughly.

UNPACKING

Unpack the juicer motor body and accessories from the carton.

Retain the carton and packing for future use. If you have to dispose of the carton and packing, please do so responsibly.

The carton should contain -

- 1 x Motor body
- 1 x Drive spindle
- 1 x Jug with storage lid
- 1 x Strainer
- 2 x Reamers (small and large)

NOTE: The two reamers are supplied assembled together.

INTRODUCTION

Citrus juicer features

- Juices citrus fruit by squeezing fruit onto a rotating reamer.
- Separates the juice and pulp through an adjustable strainer.

Juicer ingredients

The citrus juicer is suitable for juicing citrus fruits such as oranges, lemons, limes and grapefruit.

The juicer is unsuitable for juicing any other fruit or vegetables.

CONTROLS AND FEATURES

1. Drive spindle
2. Jug
3. Motor body
4. Lid
5. Large reamer
6. Small reamer
7. Strainer
8. Filter control

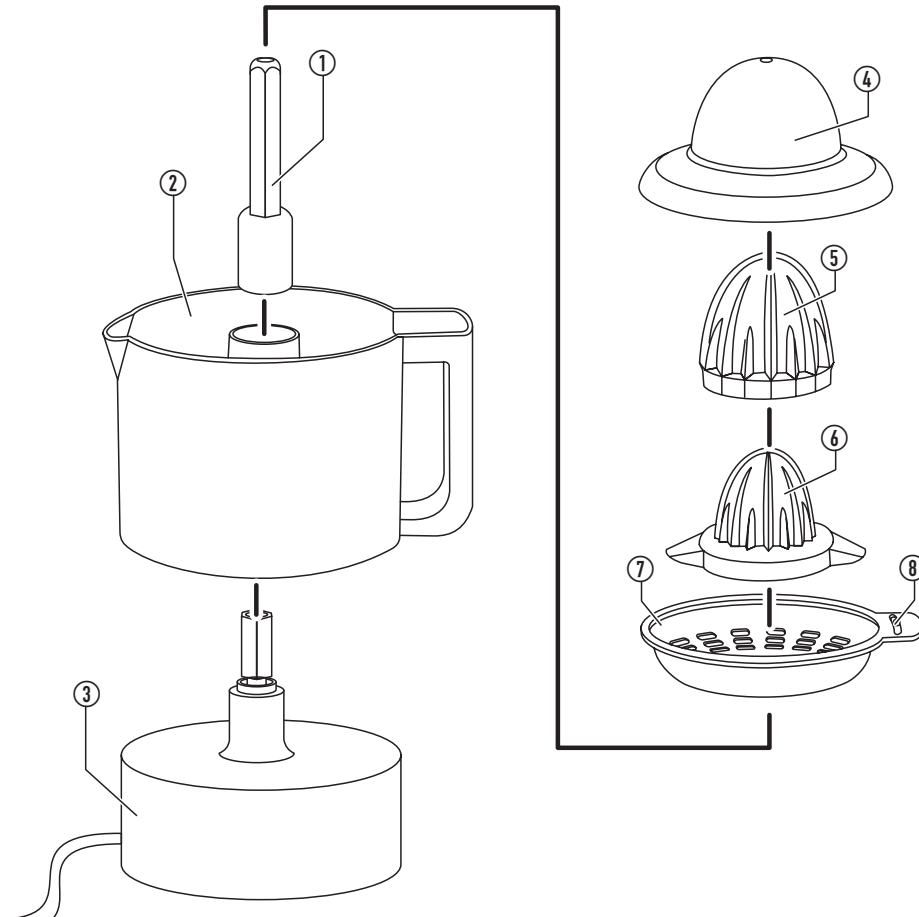

PREPARATION

Work area

Before using your juicer, prepare a clear, uncluttered work area near to a mains power outlet where the cable will not be at risk of being pulled.

First use

Before using your juicer for the first time you should ensure that the components are thoroughly cleaned.

- Follow the instructions in the Care and Cleaning section on page 5 to clean all components thoroughly before first use.

Preparing fruit or vegetables for juicing

- Always defrost frozen fruit before juicing.
- Wash and dry fruit.
- Cut the fruit in half through the segments as shown.

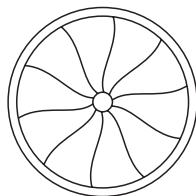

ASSEMBLY

The juicer must be fully assembled before use.

Choosing a reamer

There are two reamer sizes available - large and small. The large reamer (for larger oranges, grapefruit etc) is clipped over the small reamer (for lemons, limes etc).

- If you want to use the small reamer, squeeze the large reamer at the sides as shown and lift it off the small reamer.

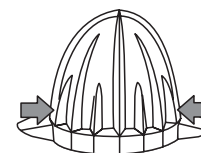

CAUTION: Never use the large reamer without clipping it over the small reamer.

Assembling the juicer

- Check that mains power is disconnected from the juicer.
- Place the drive spindle on the drive from the motor body.
- Place the jug over the spindle.
- Twist the jug to lock it to the motor body.
- Check that the jug is securely locked to the motor body.
- Place the strainer onto the top of the jug.
- Referring to the previous section, choose the small or large reamer that is most suitable for the fruit you are juicing.
- Place the reamer on the spindle.

OPERATION

Juicing

- Organise the appliance in a flat, stable workplace with good access.
- Place your prepared fruit nearby in a bowl etc.
- Connect the appliance to a convenient mains outlet.
- Set the filter control. You can choose six steps. The finest step will only allow juice to flow. All the fruit will remain in the strainer. Coarser steps will allow some of the fruit to flow through with the juice.
- There is no power switch, press the fruit gently down onto the reamer to start juicing.

NOTE: Do not use the lid during juicing. The lid is intended to cover the jug during storage.

The reamer will spin, juice will start to collect and drain through the strainer into the jug.

Never press the fruit firmly, let the reamer do the work.

- When the juice stops flowing, lift off the fruit.

The reamer will stop spinning.

- You can now juice another half fruit.

After juicing a batch of fruit

- Lift off the reamer and strainer and set them aside.
- Twist the jug to unlock it, and lift off the jug.
- Pour the juice into a storage container.
- Store your juice in the fridge.

NOTE: Operate the juicer for no more than 15 seconds repetitively - on for 15 seconds, then rest for 15 seconds. After 10 consecutive operational cycles it should be allowed to cool down for approximately 30 minutes before the next operation.

After use

- Follow the instructions in the Care and Cleaning section to clean all components thoroughly before storage.

Storage

- When all the components are dry, coil the power cable loosely and store the juicer and all accessories out of reach of children and pets.

TROUBLESHOOTING

Problem	Possible solution
No power	Check that the juicer is connected to mains power.
	Check that the all parts of the juicer are assembled correctly.
	If you have been using the juicer for a long time it may have overheated. Allow it to cool to room temperature.
Juice is not flowing into the jug	Fruit may be clogged in the strainer. Switch off power and clear the strainer before continuing.
The screw has stopped turning	Switch off immediately. Check that there are no hard stones or seeds in the ingredients that may block the juicer.
The jug is vibrating	This is normal. There will be some movement of the jug when operating.

SPECIFICATIONS

Power supply.....220-240V~, 50Hz

Power consumption..... 30W

Net weight..... 0.75kg



Class II double insulated.



E285

WARRANTY

1. Our goods come with guarantees that cannot be excluded under the Australian Consumer Law. You are entitled to a replacement or refund for a major failure and for compensation for any other reasonably foreseeable loss or damage. You are also entitled to have the goods repaired or replaced if the goods fail to be of acceptable quality and the failure does not amount to a major failure. Where a failure does not amount to a major failure, BIG W is entitled to choose between providing you with a repair, replacement or refund. To obtain compensation, you would need to provide documentary evidence of the loss or damage suffered, and documentary evidence that such loss or damage was a reasonably foreseeable consequence of a failure by BIG W to comply with a consumer guarantee under the Australian Consumer Law. Such evidence may include photographs, statutory declarations, receipts or reports (eg from your doctor), depending on the loss or damage.
2. In addition to all rights and remedies to which you may be entitled under the Competition and Consumer Act 2010 (Commonwealth), and any other relevant legislation, the manufacturer warrants this product to be free from defects in materials or workmanship for a period of 24 months from the date of purchase.
3. In order to claim under this warranty you will need to bring the product to any BIG W store, along with proof of purchase (typically this will be a receipt). Any cost incurred by you in bringing the product to the service desk will be borne by you. We will then, at our option, either repair or replace the product, or refund your money and take back the product – in accordance with our Returns Policy, a copy of which is available at our return desk
4. Our liability under this manufacturer's warranty is subject to us being satisfied that a defect was caused by defective workmanship or materials, and was not caused by or substantially contributed to by other factors, or circumstances beyond our control, including (but not limited to) defective installation, maintenance or repair, alteration or modification of the product in a manner not recommended by the manufacturers or any neglect, misuse or excessive use.
5. The benefits conferred by this manufacturer's warranty are in addition to all rights and remedies conveyed by the Competition and Consumer Act 2010 (Commonwealth), and any other statutory rights to which you may already be entitled, and this warranty does not exclude, restrict or modify any such rights or remedies that are implied by law.
6. This warranty is provided by BIG W of 1 Woolworths Way, Bella Vista NSW 2153, Phone: 1300 244 999.

contempo™

Made for Big W
1 Woolworths Way
Bella Vista NSW
2153 Australia

Made in China

CONTEMPO JC3001BA-SA V0.2