



Owner's Handbook

BL1019A-SA
Personal blender

IMPORTANT SAFETY INSTRUCTIONS	1	OPERATION	8
CONTROLS AND FEATURES	5	Blending	8
Blender components	5	Adding liquid to your blend	9
UNPACKING	6	After use	9
INTRODUCTION	6	Storage	9
Personal blender features	6	CARE AND CLEANING	10
Blender cup ingredients	6	Motor body	10
Recipe ideas	6	Cup, lid and blade assembly	10
PREPARATION	7	Dismantling the blade assembly	10
Work area	7	Re-assembling the blade assembly	11
Suction feet	7	SPECIFICATIONS	12
First use	7	WARRANTY	13
Good practice when preparing food	7		
Preparing fruit or vegetables for blending	7		
Blending with ice or frozen ingredients	7		
Blending large quantities	7		

Please keep your sales docket, including cash register receipt, in a safe place as the docket will prove the commencement of the period of this warranty. If you wish to make a claim specifically under this manufacturer's warranty, you will be required to provide proof of purchase, preferably your sales docket.

IMPORTANT SAFETY INSTRUCTIONS

Read all instructions before using and save for future reference

- Always use the appliance from a power outlet of the same voltage (A.C. only) marked on the appliance.
- Always turn the power off at the power outlet before you insert or remove a plug. Remove by grasping the plug - do not pull on the cord.
- Remove all accessories from the motor unit and remove the plug from power outlet when the appliance is not in use, before putting on or removing parts and before cleaning.
- For additional protection, it is recommended to use the appliance with a residual current device (safety switch) with a tripping current not exceeding 30mA in the power socket which supplies power to the appliance.
- If the supply cord is damaged, it must be replaced by the manufacturer or its service agent or a similarly qualified person in order to avoid a hazard.
- Do not let the power cord of the appliance hang over the edge of a table or bench top or touch any hot surface.
- Do not leave the power cord near the edge of a bench top where children may touch or pull it.
- The appliance shall not be operated by means of an external timer or separate remote control system.
- Do not place the appliance on or near a hot gas flame, electric element or on a heated oven. Do not place on top of any other appliance.
- Do not use the appliance near flammable material such as curtains, draperies and wallpaper.

IMPORTANT SAFETY INSTRUCTIONS

- This appliance is for household use only.
- Do not use outdoors.
- Do not use the appliance for any purpose other than its intended use. Always operate the appliance on a flat, level surface.
- Ensure a minimum of 20 cm space around the unit for air circulation.
- Ensure that the ventilation slots on the bottom of the unit are not blocked during use.
- Do not immerse the motor unit into water or other liquids.
- After cleaning the blender cup and other accessories, ensure that they are completely dry before using again.
- Do not place any part of the blender in a microwave.
- Take extreme care when handling the sharp blades during assembly and cleaning.
- This appliance is not suitable for use by persons (including children) who have limited physical, sensory or mental abilities, or by persons who have a lack of experience and/or lack of knowledge unless they are supervised by a person in charge for their security or receive instructions by them on how to use the appliance.
- Children should be supervised to ensure they do not play with the appliance.
- Do not leave the appliance unattended during use.

IMPORTANT SAFETY INSTRUCTIONS

- Do not move the appliance while switched on.
- The use of accessories or attachments not supplied with the appliance is not recommended.
- Avoid contact with moving parts. Keep hands, hair, clothing, as well as spatulas and other utensils away from the appliance during operation to reduce the risk of injury to persons, and/or damage.
- Do not operate the appliance for more than 3 minutes. The motor may overheat. It can be operated without interruption for a maximum of 1 minute and should be allowed to cool down for approximately 1 minute before the next operation.
- Do not pour boiling or very hot water or other liquids into the cup during use and cleaning as it can cause damage to the unit.
- Do not process hot or boiling liquids. Allow liquids to cool before placing into the blender cup.
- Do not fill the blender cup above the '600ml' mark.
- **CAUTION:** Always operate the blender with the cup fully attached and locked in place to the blade attachment before putting the cup onto the motor unit.
- Do not attempt to defeat the cup locking mechanism to turn the appliance on.
- Do not run the appliance while the cup is empty.
- Always place one hand firmly on top of the closed cup to enhance the stability of the unit during operation.

IMPORTANT SAFETY INSTRUCTIONS

- Wait until rotating components stop moving before taking off the cup.
- Do not blend with an ingredient volume capacity of less than 60ml.
- Always check the blender cup to ensure there are no signs of cracks or damage prior to use.
- Do not use the blender to blend hard or dry ingredients such as ice cubes, mixtures containing fruit stones, cereals and chocolate in lumps as these may damage the blades.
- Do not use the blender to blend frozen ingredients.
- Ensure that the rubber seal around the blade assembly is properly installed prior to use.
- **WARNING:** When assembling the cup to the blade assembly, ensure the cup is screwed tight to the blade assembly to avoid leaking.
- Be aware of potential injury from misuse.
- Care shall be taken when handling the sharp cutting blades, emptying the cup and during cleaning.
- Be careful if hot liquid is poured into the blender as it can be ejected out of the appliance due to a sudden steaming.
- Switch off the appliance and disconnect from supply before changing accessories or approaching parts that move in use.

CONTROLS AND FEATURES

Blender components

1. Motor body
2. Cup (x2)
3. Power switch
4. Blade assembly
5. Cup lid (x2)

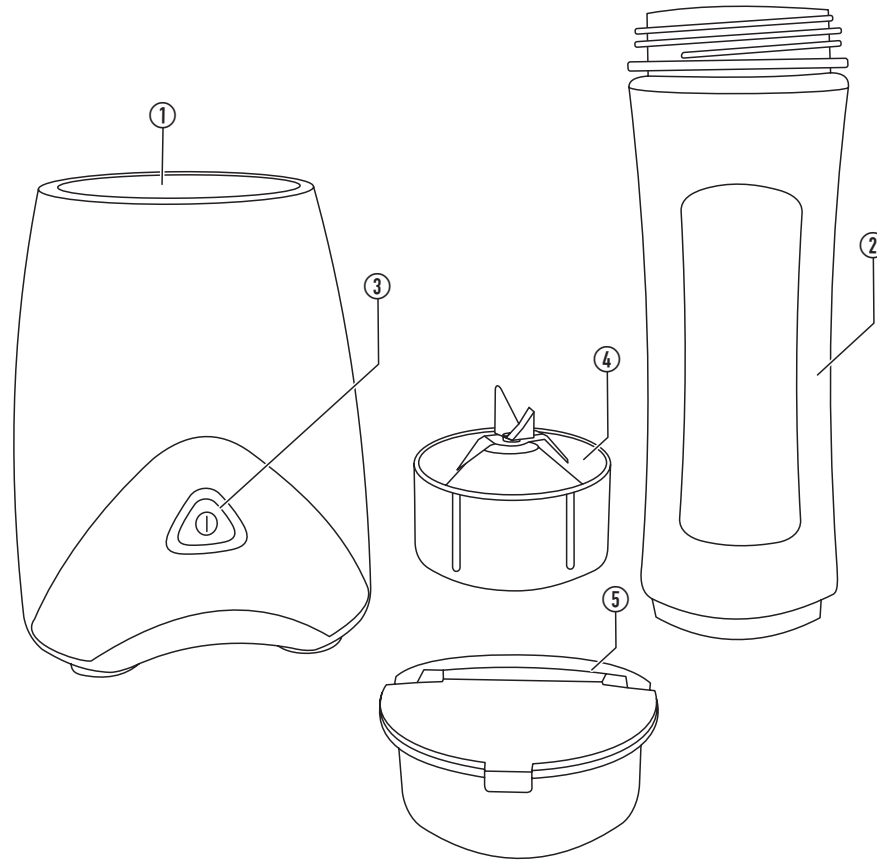

UNPACKING

Unpack the blender motor body and accessories from the carton.

Retain the carton and packing for future use. If you have to dispose of the carton and packing, please do so responsibly.

The carton should contain -

1 x Motor body

2 x Cup

2 x Cup lid

1 x Blade assembly

1 x Owner's handbook

INTRODUCTION

Personal blender features

- Personal blender that makes blended drinks and smoothies in the cup.
- Cup supplied with a drinking cap that includes a carry handle.

Blender cup ingredients

The blender is suitable for blending most types of fruits and vegetables into drinks, directly into the cup. The drinking cap enables you to blend directly into the cup then take your drink out with you.

Bananas, berries, mango, peaches, plums, nectarines, apple, pear and melon all make delicious blended drinks when blended with a little liquid. Experiment with the addition of a little milk, or dairy-free alternative, yogurt, rice milk or coconut milk.

Carrots, tomatoes, leafy vegetables, avocado, cucumber can all be blended with the addition of a little water or stock.

Add crushed ice for a cooler drink.

Recipe ideas

Some great blender recipe books are available for drinks and soups or try searching on-line for different ideas.

PREPARATION

Work area

Before using your blender, prepare a clear, uncluttered work area near to a mains power outlet where the cable will not be at risk of being pulled.

Suction feet

Your blender has two suction feet, positioned at the front (arrowed). These help stabilise the unit when you are blending. Placing the blender on a smooth, level surface will enable the suction feet to work correctly.

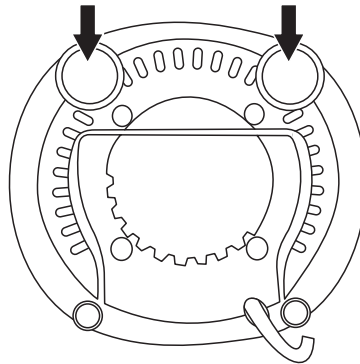

First use

Before using your blender for the first time you should ensure that the components are thoroughly cleaned.

- Follow the instructions in the Care and Cleaning section on page 10 to clean all components thoroughly before first use.

Good practice when preparing food

Wash and dry fruit or vegetables.

If preferred, peel fruit and vegetables before blending. Remove any core or pips.

Preparing fruit or vegetables for blending

Fruit and vegetables should be chopped roughly into cubes of approximately 15mm.

Blending with ice or frozen ingredients

Never blend with ice cubes, these may damage the blender. Always use crushed ice.

Frozen ingredients must be thawed before blending.

Blending large quantities

When blending large quantities of food, divide the food into batches and blend them individually. Never exceed the '600ml' mark on the cup.

OPERATION

Blending

- Place the food ingredients to be blended into the cup with any water, stock or other liquid you want to add to the blend.

If you are not sure how much liquid to add, hold some back as you can always stop the blending process and add more.

Ensure that the level of your ingredients does not exceed the '600ml' mark on the cup at any time.

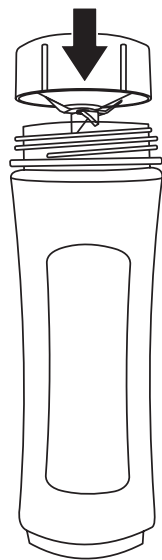

- Screw the blade assembly onto the top of the cup.

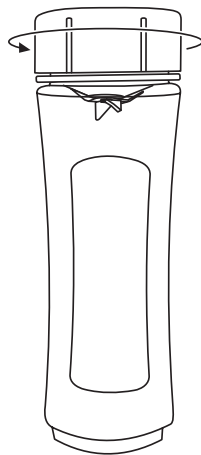

Warning: Ensure the blade assembly is screwed tight to the cup to avoid leaking.

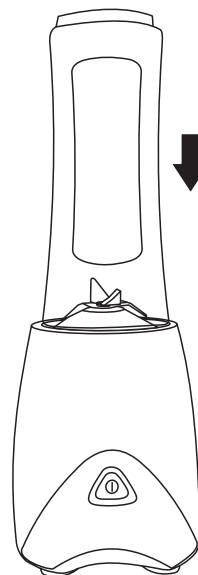

- Invert the cup and align the three lugs on the cup with the slots on the motor unit.
- Place the cup fully onto the motor unit.

- Twist the cup clockwise to lock it to the motor unit.
- Connect the power cord to a mains outlet and switch on at the outlet.
- When you are ready to start blending, press the ① button.

The motor will start.

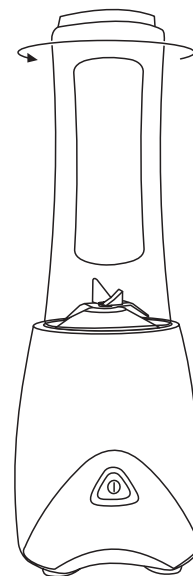

OPERATION

- Watch the blending process through the cup and release the ① button to stop the motor when you have finished blending.

Blend for a maximum of 1 minute continuously. After this, rest the appliance for 1 minute before further blending.

- Disconnect mains power.
- Unlock the cup, lift it off and invert it.
- Unscrew the blade assembly from the top of the cup.
- Screw on the cup lid to keep your blend fresh.
- You can drink the blend directly from the cup or refrigerate it to drink later.
- If you are taking your drink out with you, remember that it may need to be refrigerated to keep it fresh.

Adding liquid to your blend

During blending, you may want to add liquid as your blend progresses.

- Follow the instructions in the previous section to stop the blend, remove the cup and take off the blade assembly.
- Add liquid as required.
- Screw the blade assembly back onto the cup and continue blending as before.

After use

- Immediately after use, dismantle the blade assembly from the cup.
- Follow the instructions in the Care and Cleaning section to clean the blender components.

Storage

- When all the components are dry, coil the power cable loosely and store the blender and all accessories out of reach of children and pets.

CARE AND CLEANING

Never clean any of the components with scourers, abrasive pads or chemicals.

The components of the blender are not dishwasher safe. Never clean them in a dishwasher.

- Disconnect the motor body from mains power before cleaning it.

Motor body

- The motor body must never be immersed in water. Wipe it with a damp cloth and dry thoroughly.

Cup, lid and blade assembly

- Hand-wash these components in warm soapy water.

Take great care to keep fingers away from the cutting edges of the blades.

- Dry thoroughly before use.

NOTE: You may prefer to dismantle the blade assembly for more thorough cleaning. See the next section for more details.

Dismantling the blade assembly

You may prefer to fully dismantle the blade assembly for more thorough cleaning.

- Wrap the blade in a thick cloth to protect both your fingers and the blade.
- Using finger pressure, ease out the clips (marked) under the blade assembly one by one. This will release the inner disc of the blade assembly from the outer holder.

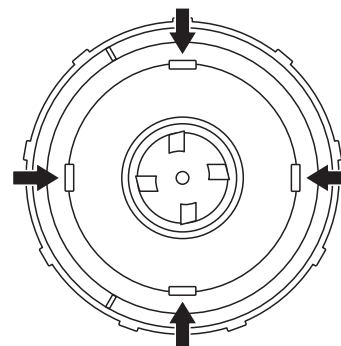

The inner part of the blade assembly will now push out.

CARE AND CLEANING

- Remove the rubber seal from the rim of the inner disc.

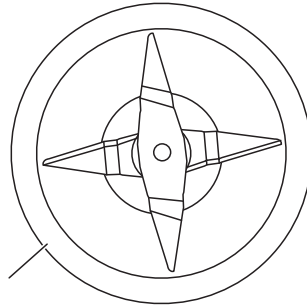

Rubber seal

- Wash all parts of the blade assembly in warm, soapy water.
Take great care to keep fingers away from the cutting edges of the blades.
- Allow the components to dry completely before reassembly.

Re-assembling the blade assembly

Take great care to keep fingers away from the cutting edges of the blades when re-assembling the blade assembly.

- Fit the rubber seal to the rim of the inner disc.

The seal is symmetrical so can be fitted either way up.

CAUTION: Ensure the rubber seal is correctly and securely assembled around the rim of the inner disc.

- With the blade facing upwards, place the inner disc into the threaded end of the outer holder.
- Taking great care to keep fingers away from the cutting edges of the blades, press the disc evenly into the outer holder until all four clips click into place.
- Assembly is now complete.

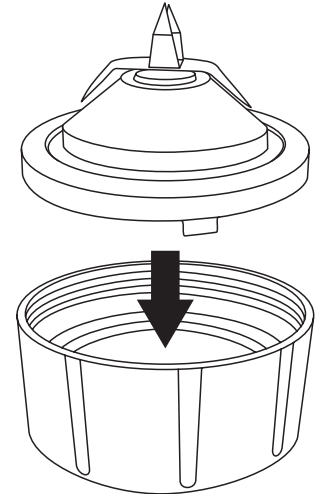

SPECIFICATIONS

Power supply 230-240V~, 50Hz

Power consumption..... 280-300W

Net weight (including 2 cups and 2 lids) 1.23kg



Class II double insulated.



E285

WARRANTY

1. Our goods come with guarantees that cannot be excluded under the Australian Consumer Law. You are entitled to a replacement or refund for a major failure and for compensation for any other reasonably foreseeable loss or damage. You are also entitled to have the goods repaired or replaced if the goods fail to be of acceptable quality and the failure does not amount to a major failure. Where a failure does not amount to a major failure, BIG W is entitled to choose between providing you with a repair, replacement or refund. To obtain compensation, you would need to provide documentary evidence of the loss or damage suffered, and documentary evidence that such loss or damage was a reasonably foreseeable consequence of a failure by BIG W to comply with a consumer guarantee under the Australian Consumer Law. Such evidence may include photographs, statutory declarations, receipts or reports (eg from your doctor), depending on the loss or damage.
2. In addition to all rights and remedies to which you may be entitled under the Competition and Consumer Act 2010 (Commonwealth), and any other relevant legislation, the manufacturer warrants this product to be free from defects in materials or workmanship for a period of 24 months from the date of purchase.
3. In order to claim under this warranty you will need to bring the product to any BIG W store, along with proof of purchase (typically this will be a receipt). Any cost incurred by you in bringing the product to the service desk will be borne by you. We will then, at our option, either repair or replace the product, or refund your money and take back the product – in accordance with our Returns Policy, a copy of which is available at our return desk
4. Our liability under this manufacturer's warranty is subject to us being satisfied that a defect was caused by defective workmanship or materials, and was not caused by or substantially contributed to by other factors, or circumstances beyond our control, including (but not limited to) defective installation, maintenance or repair, alteration or modification of the product in a manner not recommended by the manufacturers or any neglect, misuse or excessive use.
5. The benefits conferred by this manufacturer's warranty are in addition to all rights and remedies conveyed by the Competition and Consumer Act 2010 (Commonwealth), and any other statutory rights to which you may already be entitled, and this warranty does not exclude, restrict or modify any such rights or remedies that are implied by law.
6. This warranty is provided by BIG W of 1 Woolworths Way, Bella Vista NSW 2153, Phone: 1300 244 999.

contempoTM

Made for Big W
1 Woolworths Way
Bella Vista NSW
2153 Australia

Made in China

CONTEMPO BL1019A-SA V0.4