

**contempo**™

# Owner's Handbook

CH1110BH  
Mini Chopper



IMPORTANT SAFETY INSTRUCTIONS .....	1
CONTROLS AND FEATURES.....	5
UNPACKING.....	5
BLADE PROTECTION .....	5
ASSEMBLING THE CHOPPER.....	6
Blade assembly.....	6
Bowl cover .....	6
Fitting the motor body .....	6
DISMANTLING THE CHOPPER .....	7
Removing the motor body.....	7
Removing the bowl cover and blade .....	7
OPERATION .....	7
First use .....	7
Food suitable for chopping.....	7
Chopping .....	8
Maximum operating time.....	8
When you have finished chopping .....	8
After use .....	8
CARE AND CLEANING .....	9
SPECIFICATIONS.....	9
WARRANTY.....	10

Please keep your sales docket, including cash register receipt, in a safe place as the docket will prove the commencement of the period of this warranty. If you wish to make a claim specifically under this manufacturer's warranty, you will be required to provide proof of purchase, preferably your sales docket.

### IMPORTANT SAFETY INSTRUCTIONS



Please read these instructions carefully before using the appliance for the first time.

- Always use the appliance from a power outlet of the same voltage (A.C. only) marked on the appliance.
- Always turn the power off at the power outlet before you insert or remove a plug. Remove by grasping the plug - do not pull on the cord.
- Turn the power off and remove the plug from power outlet when appliance is not in use, before putting on or removing parts and before cleaning.

## IMPORTANT SAFETY INSTRUCTIONS

- Handle the blade and attachments with care. The blades are razor sharp and should be kept out of reach of children.
- Do not immerse the motor or control unit into water or other liquids.
- After cleaning the appliance, ensure that it is completely dry before using again.
- Ensure the appliance lid is in place before operating the unit.
- If the supply cord is damaged, it must be replaced by the manufacturer or its service agent or a similarly qualified person in order to avoid a hazard.
- The appliance shall not be operated by means of an external timer or separate remote control system.
- Do not let the power cord of appliance hang over the edge of a table or bench top or touch any hot surface.
- Do not place the appliance on or near a hot gas flame, electric element or on a heated oven. Do not place on top of any other appliance.
- Keep fingers well away from moving parts.
- Do not remove the cover until the blade has stopped.
- Do not attempt to operate the appliance without the cover in place.
- For additional protection, it is recommended to use appliance with a residual current device (safety switch) with a tripping current not exceeding 30mA in the power socket which supply power to the appliance.
- Do not leave the power cord near the edge of a bench top where children may touch or pull it.
- Children should be supervised to ensure they do not play with the appliance.

## IMPORTANT SAFETY INSTRUCTIONS

- 
- Do not attempt to operate the appliance by any method other than those described in this user manual to avoid potential injury from misuse.
  - Do not leave the appliance unattended during use.
  - This appliance is not intended for use by persons (including children) with reduced physical, sensory or mental capabilities, or lack of experience and knowledge, unless they have been given supervision or instruction concerning use of the appliance by a person responsible for their safety.
  - Do not move the appliance while switched on.
  - Always operate the appliance on a flat, level surface.
  - Do not use outdoors.
  - The use of accessories or attachments not supplied with the appliance is not recommended.
  - Avoid contact with moving parts. Keep hands, hair, clothing, as well as spatulas and other utensils away from the appliance during operation to reduce the risk of injury to persons, and/or damage to the appliance.
  - Do not continuously operate the appliance for too long. The motor may overheat. It can be operated without interruption for a maximum of 30 seconds and should be allowed to cool down for approximately 2 minutes before the next operation. After 3 operations allow the appliance to cool to room temperature before further use.
  - Take care when handling the sharp blades and during cleaning.
  - Never process very hot liquids. **DANGER OF SCALDING!**
- 

## IMPORTANT SAFETY INSTRUCTIONS

- Do not operate any appliance with a damaged cord or plug or after the appliance malfunctions or is dropped or damaged in any manner. Return the appliance to the nearest authorised service facility for examination, repair or electrical or mechanical adjustment.
- Do not use the appliance with an extension power board.
- Always clean the appliance components thoroughly when changing between ingredients, particularly after chopping meat.
- Do not use the unit to chop hard ingredients such as coffee beans, ice cubes, mixtures containing fruit stones cereals and chocolate in lumps as these may damage the blades.
- Check the glass bowl to make sure there are no signs of cracks or damage prior to each use. Do not use the bowl if there are any signs of damage. Do not fill above the maximum level marked on the bowl.
- Be careful if hot liquid is poured into the mini chopper as it can be ejected out of the appliance due to a sudden steaming.
- This appliance is intended to be used in household and similar applications such as:
  - Staff kitchen areas in shops, offices and other working environments,
  - Farm houses,
  - By clients in hotels, motels and other residential type environments,
  - Bed and breakfast type environments.
- Care shall be taken when handling the sharp cutting blades, emptying the bowl and during cleaning.
- Switch off the appliance and disconnect from supply before changing accessories or approaching parts that move in use.

### CONTROLS AND FEATURES

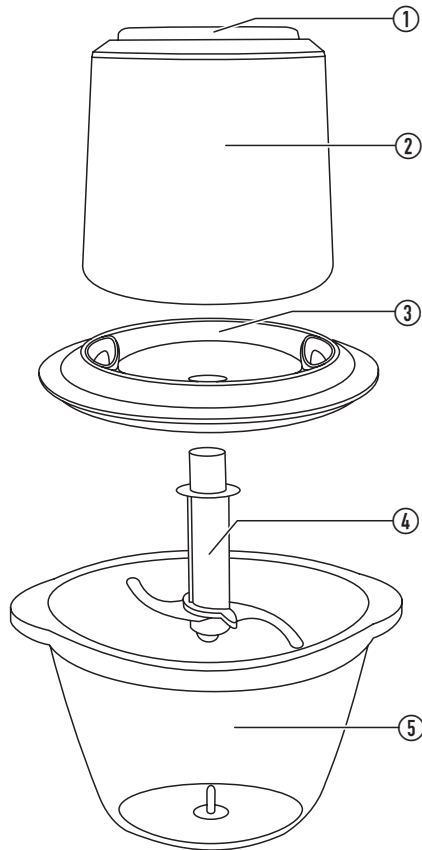

1. Power switch
2. Motor body
3. Bowl cover
4. Blade assembly
5. Bowl

### UNPACKING

Unpack the mini chopper from the carton.

Retain the carton and packaging materials for future use. If you have to dispose of the carton and packaging materials, please dispose of them according to your local legislations.

The carton contains -

1 x CH-1110BH Mini chopper

1 x Owner's handbook.

### BLADE PROTECTION

The blade assembly is packed with a clear protective cover over the blade. Remove this cover before assembling the appliance for the first time.

**CAUTION:** When removing the cover, hold the blade assembly by the plastic spindle, and take care not to touch the blades as they are sharp.

## ASSEMBLING THE CHOPPER

The Mini chopper is assembled from four parts - the motor body, bowl cover, blade and bowl.

Always disconnect mains power before assembling the chopper.

**CAUTION:** Always handle the blade assembly by the plastic spindle, never touch the blades as they are sharp.

### Blade assembly

- To fit the blade assembly, drop the blade assembly over the central guide in the bowl.

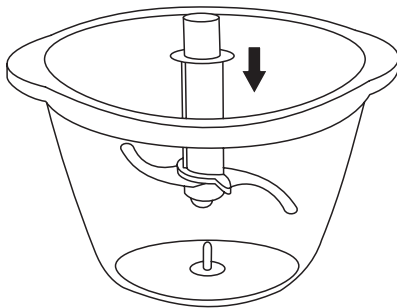

### Bowl cover

- Place the cover on the bowl.

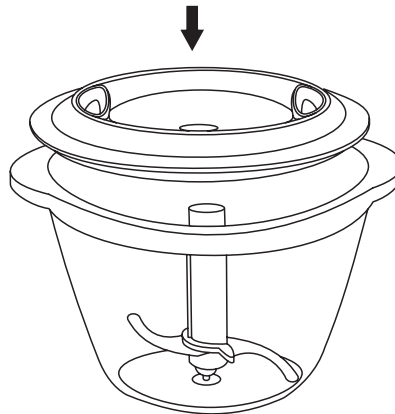

### Fitting the motor body

- Line up the motor body with the bowl cover and place the motor body on the bowl cover.

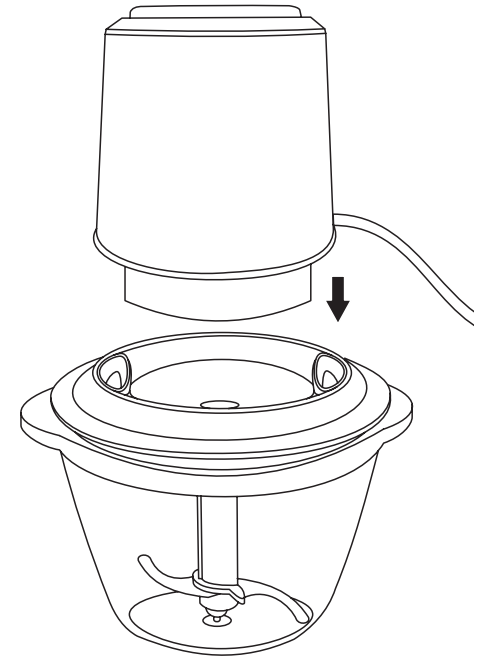

## **DISMANTLING THE CHOPPER**

Always disconnect mains power before dismantling the chopper.

### **Removing the motor body**

- Hold the bowl and lift the motor body from the bowl.

### **Removing the bowl cover and blade**

- Lift the bowl cover off the bowl.
- With the bowl cover removed, lift the blade out by the plastic spindle.

**CAUTION:** Always handle the blade assembly by the plastic spindle, never touch the blades as they are sharp.

## **OPERATION**

### **First use**

Before using your chopper for the first time you should ensure that the chopper components are thoroughly cleaned.

- Clean all components as directed in the Care and Cleaning section.
- Dry all components thoroughly before re-assembly.

### **Food suitable for chopping**

The chopper can be used to chop meat, fruit, vegetables, fresh garlic and ginger, hard cheeses, nuts and herbs (coarse chop).

Never chop anything that is extremely hard such as fruit containing stones, meat bones, frozen food or ice.

Never chop any hot food.



## OPERATION

### Chopping

- Make sure that the power is disconnected.
- Place the bowl on a level, flat surface.
- Assemble the blade in the bowl.
- Place the food to be chopped evenly in the bowl.

**CAUTION:** Never fill the bowl above the MAX mark.

- Fit the bowl cover.
- Fit the motor body.
- Connect the power cable to a mains outlet.
- Steady the bowl with one hand.
- Press the top of the motor body to operate the chopper.

**CAUTION:** If there is an abnormal smell or noise, stop operating the chopper immediately, disconnect the power supply and contact Customer Service on the phone number provided in Warranty page.

- Release the power switch at any time to stop the chopper and check progress through the side of the glass bowl.
- If you need to distribute the food around the bowl, release the power switch, disconnect from mains power, remove the motor body and cover and use a spoon to distribute the food. Never use your fingers.

### Maximum operating time

You can run the chopper for a maximum of 30 seconds continuously or total for a series of bursts.

After running the chopper for 30 seconds, leave it to cool for two minutes before using it again. After three operations, allow the appliance to cool to room temperature before further use.

### When you have finished chopping

- When the food is chopped as you want, release the power switch and disconnect the power supply.
- Wait until the blades have stopped and remove the motor body and bowl cover.
- Lift out the blade assembly.

### After use

- Follow the instructions in the Care and Cleaning section to clean the chopper parts.
- When the components have dried, re-assemble the chopper.
- Coil the power cable loosely and store the chopper in a safe place out of the reach of children.

### CARE AND CLEANING

**CAUTION:** Disconnect the chopper from mains power before cleaning it.

**CAUTION:** Never clean the chopper parts with scourers, abrasive pads or chemicals.

- Dismantle the motor body, bowl cover, blade assembly and bowl.
- Remove the rubber seal from the bowl cover.

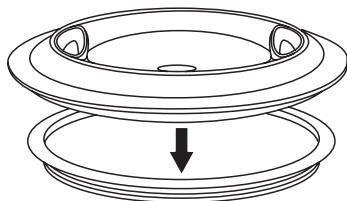

- Hand-wash the bowl, cover, rubber seal and blade assembly in hot soapy water. Take care when washing the blade as it is sharp.
- Wipe the motor body with a damp cloth.
- Dry all parts thoroughly before re-assembly.
- Re-assemble the chopper.

### SPECIFICATIONS

Power supply..... 220 - 240V~, 50/60Hz

Power consumption..... 400W

Weight..... 1.62kg



Class II double insulated.



## WARRANTY

1. Our goods come with guarantees that cannot be excluded under the Australian Consumer Law. You are entitled to a replacement or refund for a major failure and for compensation for any other reasonably foreseeable loss or damage. You are also entitled to have the goods repaired or replaced if the goods fail to be of acceptable quality and the failure does not amount to a major failure. Where a failure does not amount to a major failure, BIG W is entitled to choose between providing you with a repair, replacement or refund. To obtain compensation, you would need to provide documentary evidence of the loss or damage suffered, and documentary evidence that such loss or damage was a reasonably foreseeable consequence of a failure by BIG W to comply with a consumer guarantee under the Australian Consumer Law. Such evidence may include photographs, statutory declarations, receipts or reports (eg from your doctor), depending on the loss or damage.
2. In addition to all rights and remedies to which you may be entitled under the Competition and Consumer Act 2010 (Commonwealth) and any other relevant legislation, the manufacturer warrants this product to be free from defects in materials or workmanship for a period of 24 months from the date of purchase.
3. In order to claim under this warranty you will need to bring the product to any BIG W store, along with proof of purchase (typically this will be a receipt). Any cost incurred by you in bringing the product to the service desk will be borne by you. We will then, at our option, either repair or replace the product, or refund your money and take back the product – in accordance with our Returns Policy, a copy of which is available at our return desk
4. Our liability under this manufacturer's warranty is subject to us being satisfied that a defect was caused by defective workmanship or materials, and was not caused by or substantially contributed to by other factors, or circumstances beyond our control, including (but not limited to) defective installation, maintenance or repair, alteration or modification of the product in a manner not recommended by the manufacturers or any neglect, misuse or excessive use.
5. The benefits conferred by this manufacturer's warranty are in addition to all rights and remedies conveyed by the Competition and Consumer Act 2010 (Commonwealth), and any other statutory rights to which you may already be entitled, and this warranty does not exclude, restrict or modify any such rights or remedies that are implied by law.
6. This warranty is provided by BIG W of 1 Woolworths Way, Bella Vista NSW 2153, Phone: 1300 244 999.



**contempo<sup>TM</sup>**

**Made for Big W**  
1 Woolworths Way  
Bella Vista NSW  
2153 Australia

Made in China

CONTEMPO CH1110BH V0.1

